

INSTALLATION MANUAL

AIR ADS RGBW CONTROLLER

WI-FI COLOR CONTROLLING MODULE

Model: ADS-4CH-0-10V



PRODUCT INFORMATION

This product is WiFi-operated controller module designed to convert a traditional light or curtain switch into a smart one with the capability for remote control.

PRODUCT SPECIFICATIONS

	Input	Input voltage	12-32 V DC
	Output	Number of channels Voltage	4 0-10V for signal dimming
	TIS AIR	WIFI signal Protocol standard	2.4 GHz 802.11 b/g/n
	Reaction time		approx. 30ms
	Mounting	Free locate	Can be installed anywhere
	Operation	Digital inputs TIS AIR PRG button with LED Upgrading	4 dry inputs for control TIS protocol messages & commands For programming Over WIFI connection
	Dimensions	(Width × Length × Height)	35mm × 50mm × 50mm
	Housing	Materials Internal parts color IP rating	Fireproof PC White IP 50

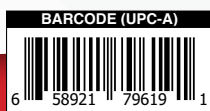



Read Instructions

We recommend that you read this Instruction Manual before installation.



Mounting Location

Install in a dry, indoor area with a suitable temperature and humidity range.



Safety instructions

Electrical equipment should only be installed and fitted by electrically skilled persons. Failure to observe the instructions may cause damage to the device and other hazards. These instructions are an integral part of the product and must remain with the end customer.



Warranty

There is a two-year warranty provided by law. The hologram warranty seal and product serial number are available on each device.



Programming

This device can be tested and programmed manually. Advanced programming requires knowledge of the TIS Device Search software and instruction in the TIS advanced training courses.



Simple Installation

it fits on most junction box sizes or can be located anywhere.





INSTALLATION STEPS

1»

Turn off the power at the main circuit breaker to turn off voltage supply to the switch.

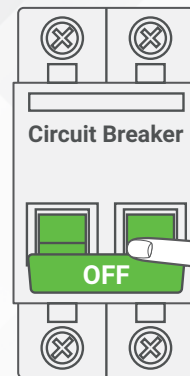

WARNING! HIGH VOLTAGE

2»

Attach the GND and 12-32V DC wires to the TIS module “-” & “+” terminals, respectively.

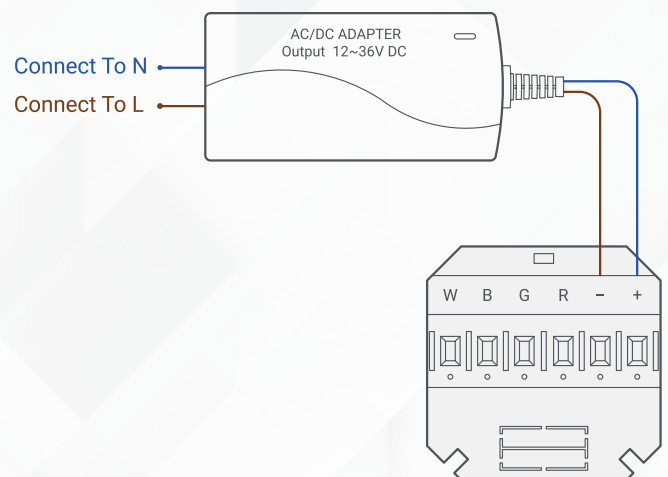

3»

Connect TIS module R, G, B, W wires to the 0-10V inputs (ch1, ch2, ch3, ch4) of any 0-10V driver terminals, respectively.

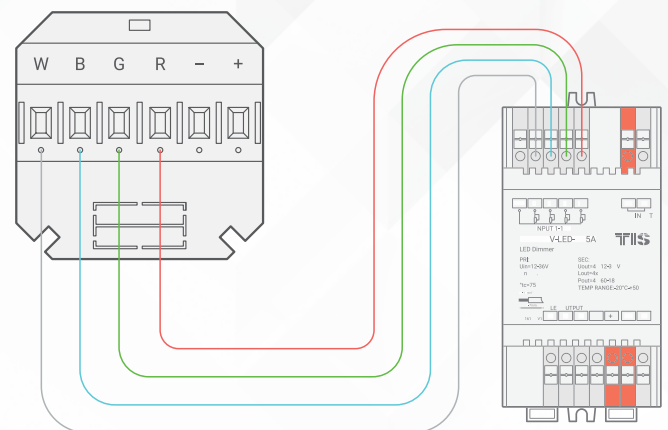



INSTALLATION STEPS

4

Connect TIS module “-” wire terminals to the GND “0” input of the 0-10V driver terminals.

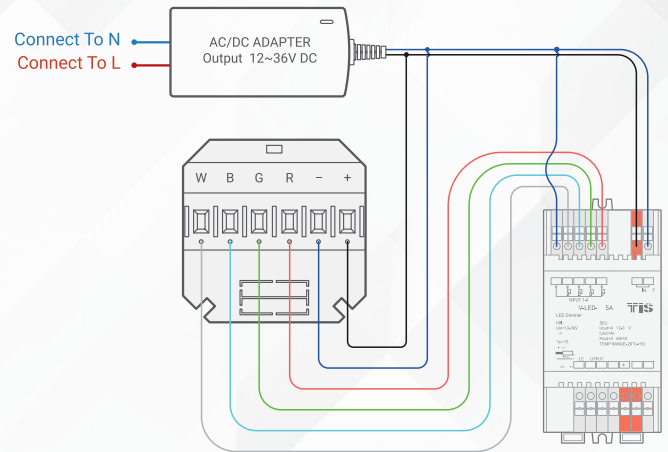

5

Connect the LED lights wires to the 0-10V driver.

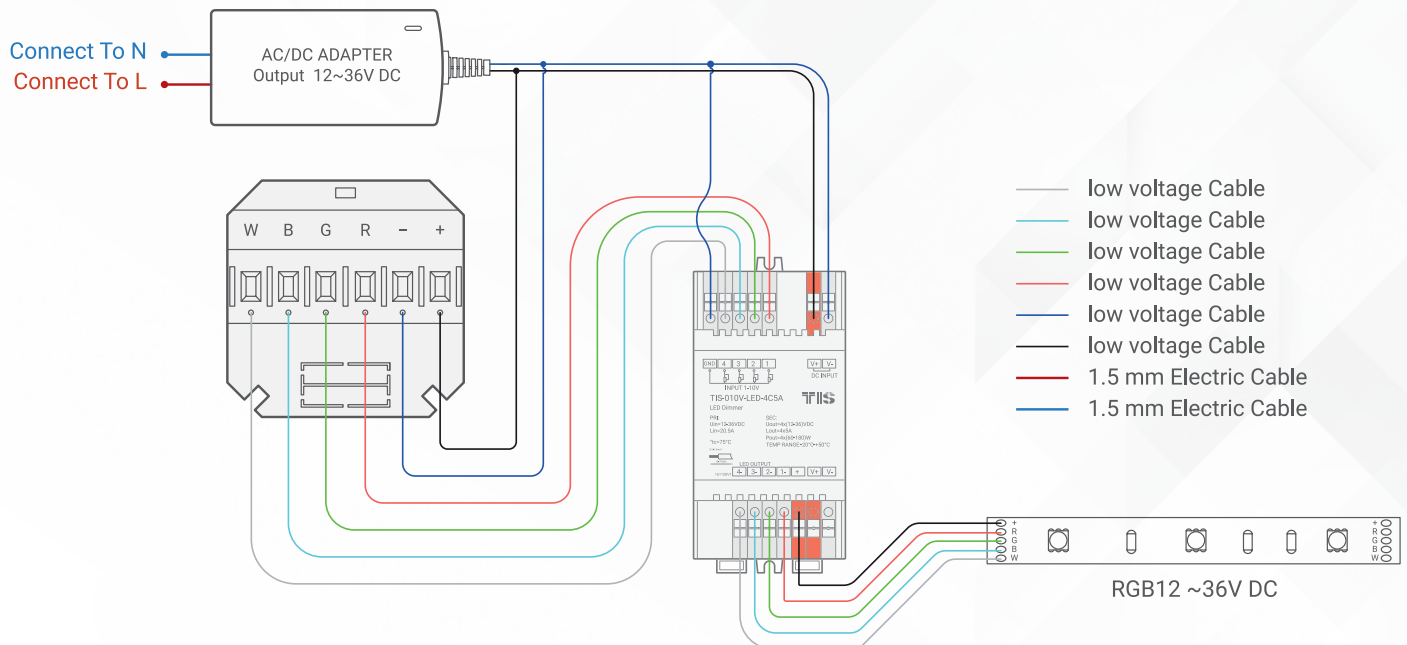

INSTALLATION STEPS

- 6** Connect the 4 Dry inputs wires to the wall switch or any 3rd party sensor.

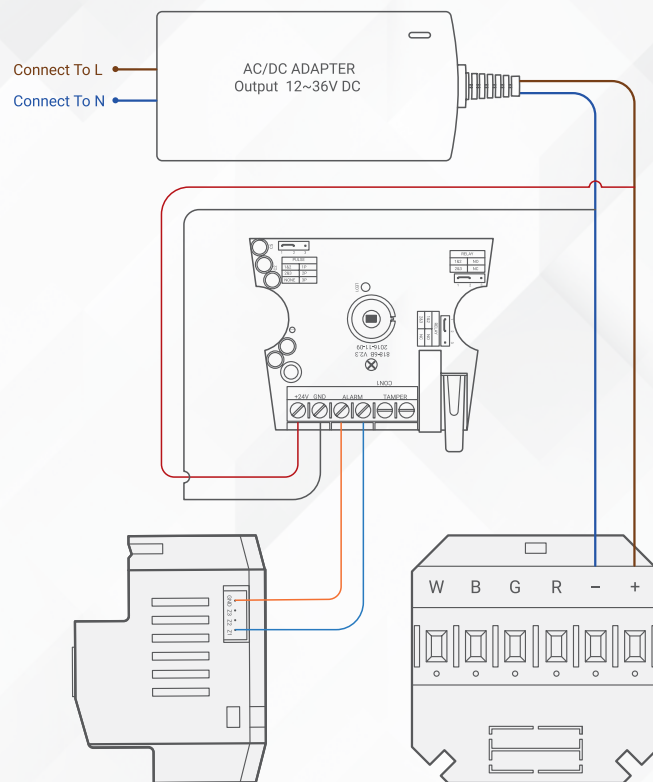

- 7** Turn on the breaker. The module should turn on accordingly.

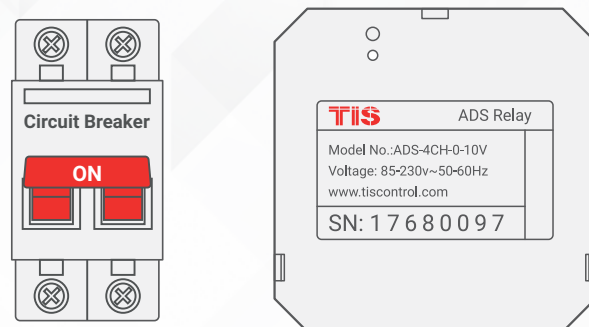

SERVER LINKING

In order for a project to be fully linked to the TIS server, server configuration must be enabled in just 1 product within that project.

If you have already done that with any other panel, just ignore these steps and proceed to configuration steps.

To do the server linking, complete the following steps:

- 1» In the TIS App, go to Settings ► Connect Server, and follow the steps by entering your SSID password.

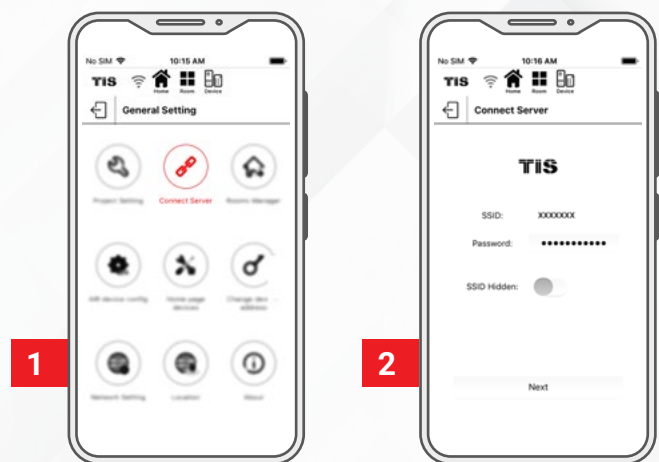

- 2» On the module, press and hold the PRG button for 6 seconds. The PRG LED will start blinking.

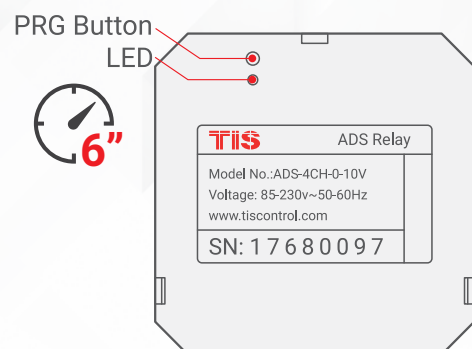

SERVER LINKING

- 3»** On the TIS app, press Search and wait for a few seconds. The panel will link to your Wi-Fi, and the PRG button will turn blue.

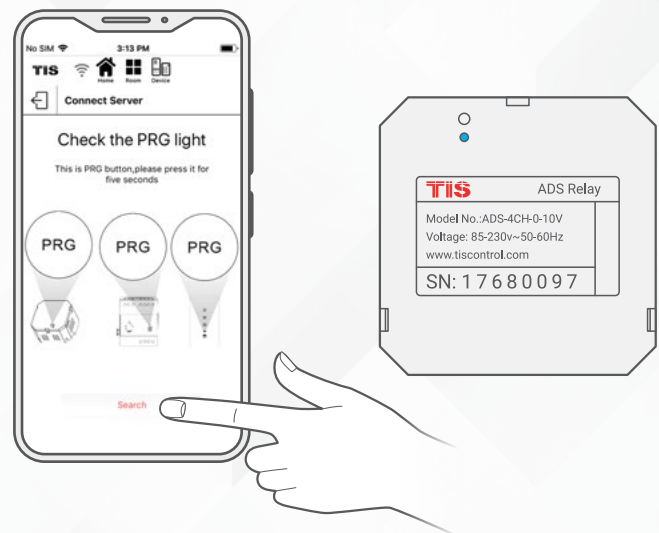

- 4»** Select your server option and 4-digit password. Then, press Save.

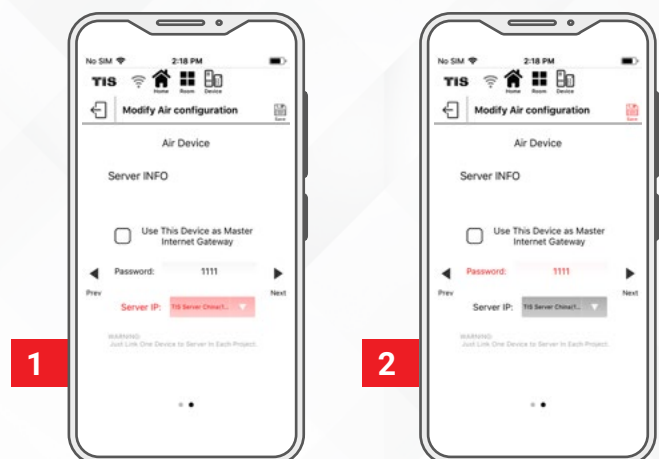

CONFIGURATION STEPS

1 In the TIS App, go to the Settings ► AIR Device Configuration, and follow the steps by entering your SSID password.

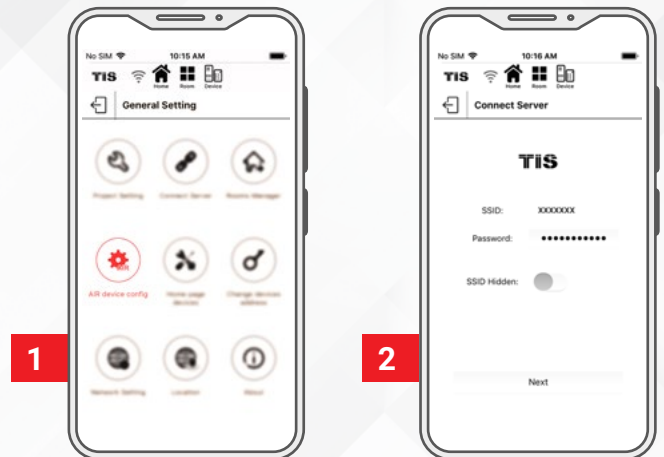

2 On the module, press and hold the PRG button for 6 seconds. The PRG LED will start blinking.

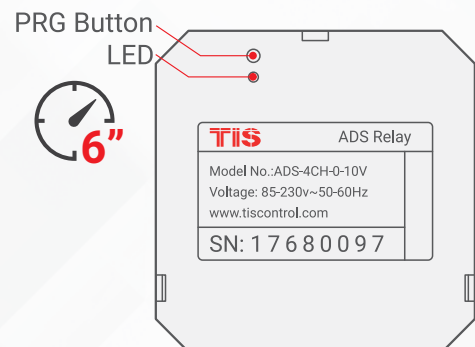

3 On the TIS app, press Search and wait for a few seconds. The module will link to your Wi-Fi, and the PRG LED will turn blue.



CONFIGURATION STEPS

4» Select the room; then, select channel names and icons.

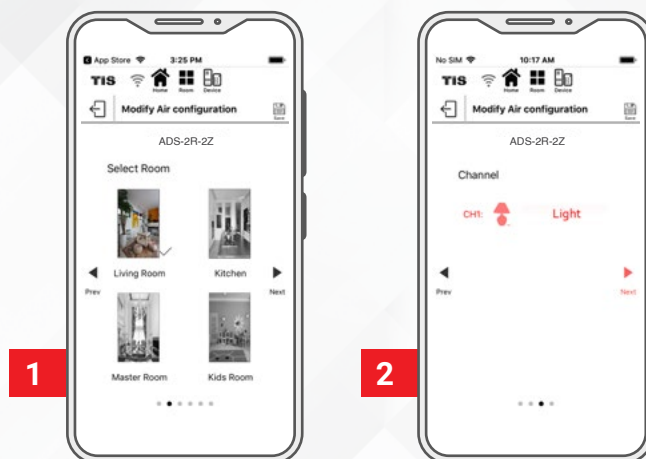

5» Go to the configured room's page and start controlling.

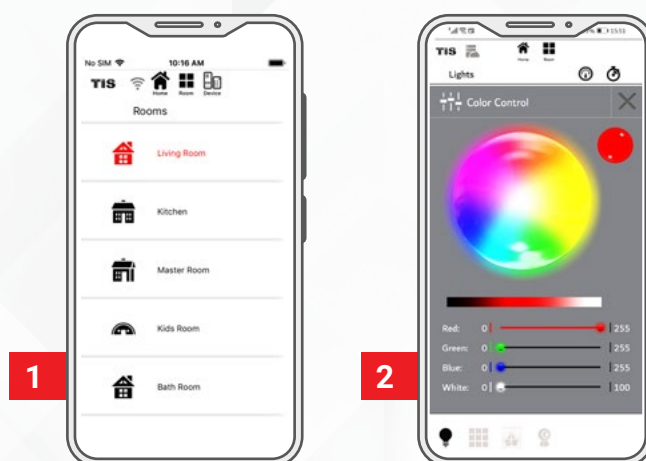



PAIRING (MANUAL PROGRAMMING)

To pair the TIS ADS module with any TIS wall panel buttons, do the following:

1 »

Short press on the PRG button five times in a row until the PRG LED starts to blink every 2 seconds.

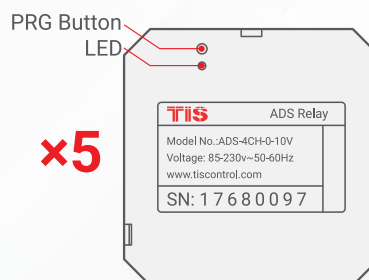

2 »

Go to any other wall panel and short press on any lighting button.

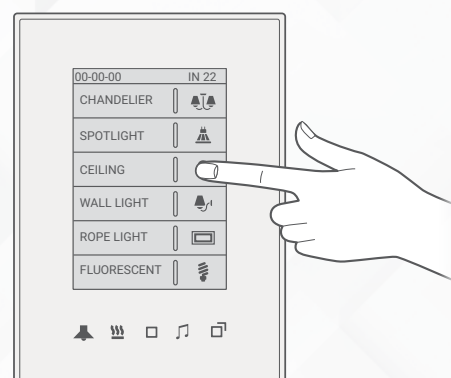

3 »

Test by pressing on the wall panel's ON/OFF button. The module should respond by turning ON and OFF accordingly.

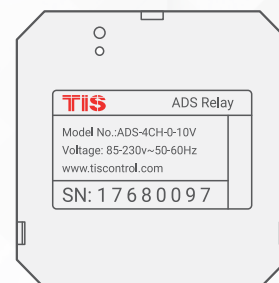
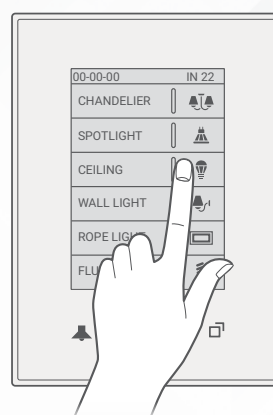

PAIRING (MANUAL PROGRAMMING)

4» The same procedure must be followed to program other channels. The only exception is that you must press the PRG button six, seven, and eight times for channels 2, 3, and 4 accordingly. The following table displays method info in detail.

METHOD	RESPONSE
Channel 1: 5 Short presses on the PRG button	PRG LED blinks once every 2 seconds
Channel 2: 6 Short presses on the PRG button	PRG LED blinks twice every 2 seconds
Channel 3: 7 Short presses on the PRG button	PRG LED blinks three times every 2 seconds
Channel 4: 8 Short presses on the PRG button	PRG LED blinks four times every 2 seconds

USER OPERATION

» Use your mobile app or smart wall switches to control lights color.

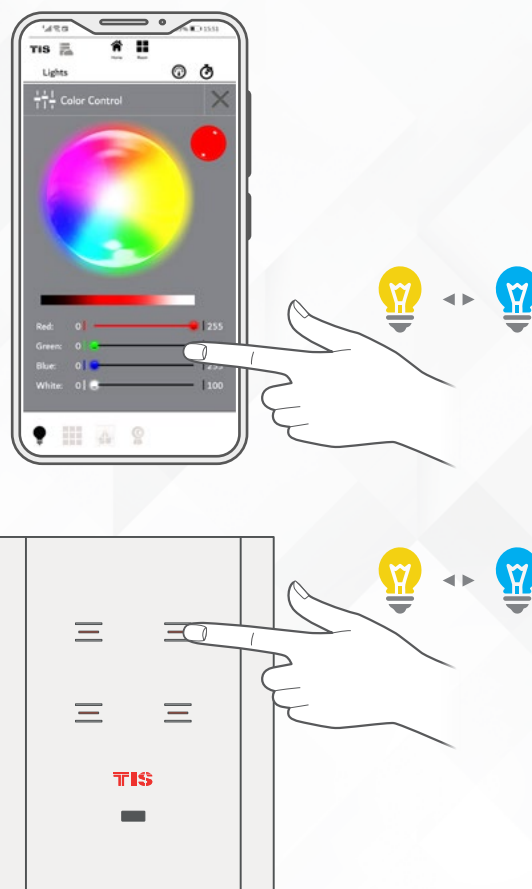



TROUBLESHOOTING



PRG button blinks purple color rapidly

Reason: The panel address conflicts with another device in the TIS network. You need to press and hold the PRG button for 6 seconds so that the module can get a new address.



Device's PRG LED is RED

Reason: The device is not connected to Wi-Fi.



Device can't link to Wi-Fi router

Reason 1: The device is too far from the WiFi router.

Reason 2: The SSID or password is not correct.

Reason 3: Some setting in the WIFI router is preventing new devices from being added.



Other wall panels can't pair with the device

Reason 1: Other panel connections are not linked to the same Wi-Fi network.

Reason 2: The manual programming function is disabled in the device (default is enabled).



Other wall panels can't control the device channels

Reason 1: Other panel connections are not linked to the same Wi-Fi network.

Reason 2: The programming address is wrong.