

INSTALLATION MANUAL

TIS LUNA CARD SWITCH

Card Holder Panel

MODEL: LUNA-CARD



i PRODUCT INFORMATION

This product is a programmable card reader device designed for hospitality facilities. Placed in corridor next to a room door, it provides access control by communicating with RFID cards.

PRODUCT SPECIFICATIONS

 Inputs	RF card reader	Temic RF type
 TIS Bus	Number of devices on 1 line Bus voltage Current consumption	Max. 64 12-32 V DC <25 mA / 24 V DC
 Protection		Reverse polarity protection ESD protection
 Operation	Card switch TIS bus Upgrading	Card RF reader TIS Protocol messages and commands By Rs485 upgrading kit
 Functions	CARD Switch	To turn off lights if no occupancy or if card removed
 Dimensions	Width x Length x Height	129mm x 20mm x 94mm
 Housing	Materials Casing color Button color IP rating	Fireproof PC / Glass in front Silver plating frame. Glass black Silver IP 50

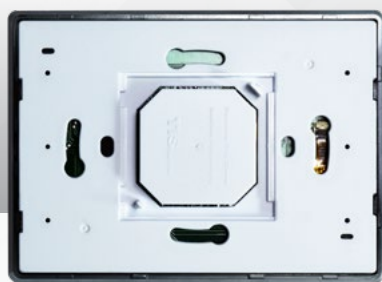

BARCODE (UPC-A)





Read Instructions

We recommend that you read this Instruction Manual before installation.



Mounting Location

Install in a dry, indoor area with a suitable temperature and humidity range.



Safety instructions

Electrical equipment should only be installed and fitted by electrically skilled persons.

Failure to follow the instructions may cause damage to the device and other hazards.

These instructions are an integral part of the product and must remain with the end customer.



Data Cable

Use screened stranded RS485 data cable with four twisted pairs. Configure devices in a "Daisy Chain."

Do not cut or terminate live data cables.



Programming

Advanced programming requires knowledge of the TIS Device Search software and instruction in the TIS advanced training courses.



Warranty

There is a two-year warranty provided by law. The hologram warranty seal and product serial number are available on each device.



Simple Installation

You can use 2 screws to install this panel on wall; it fits on most junction box sizes.





INSTALLATION STEPS

1

Insert a large flathead screwdriver in the hole of the Panel Cover. Rotate the screwdriver 90 degrees.

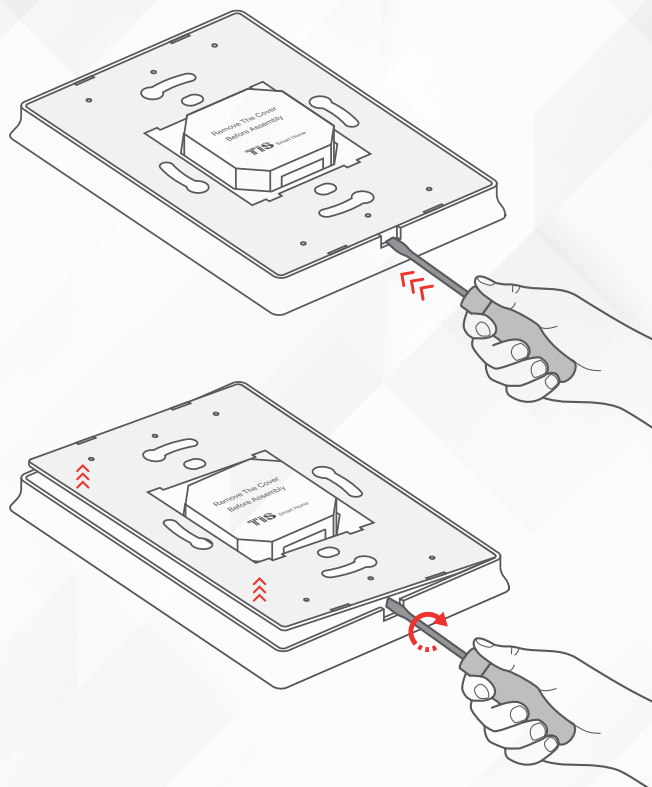

2

Separate the Main Panel and Wall Base from each other.

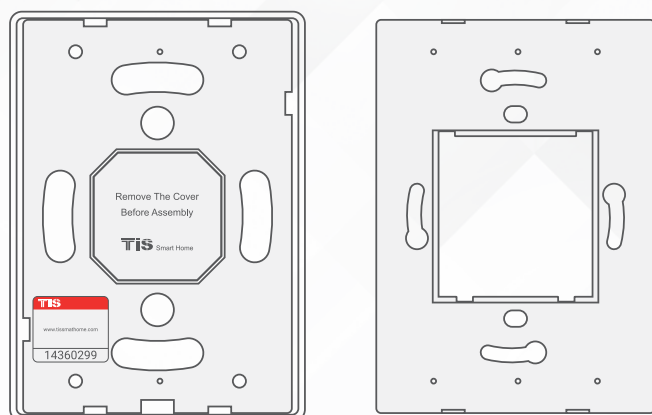



INSTALLATION STEPS

3»

Turn off the main electrical source before installation.



WARNING! HIGH VOLTAGE

4»

Connect the Cat5e TIS BUS wire to the Panel Addition.

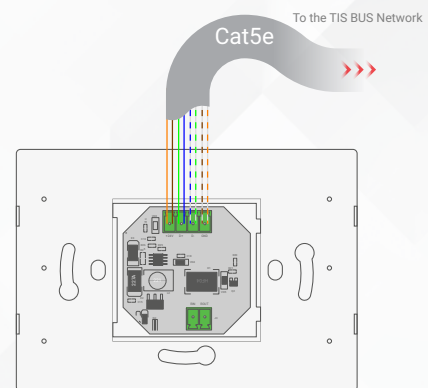

5»

Connect the other connection if needed between wall services switches to the digital inputs of the hotel panel as per the following diagram.

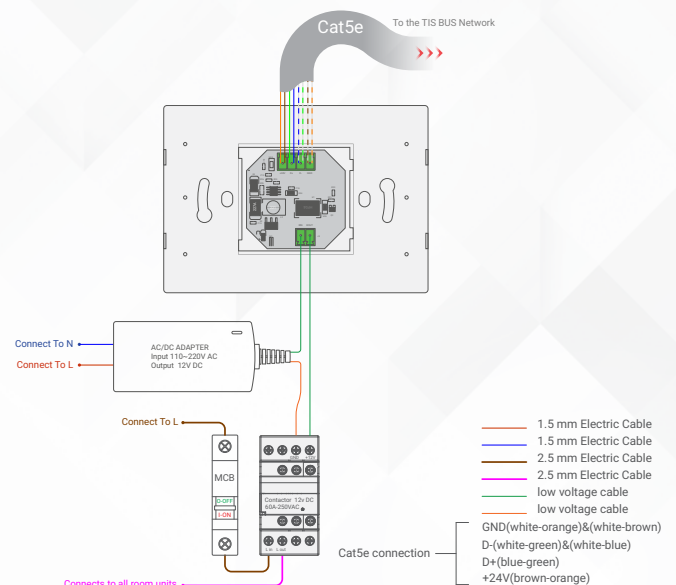



INSTALLATION STEPS

6

Connect the Door Bell to the Relay if it exists in the room.

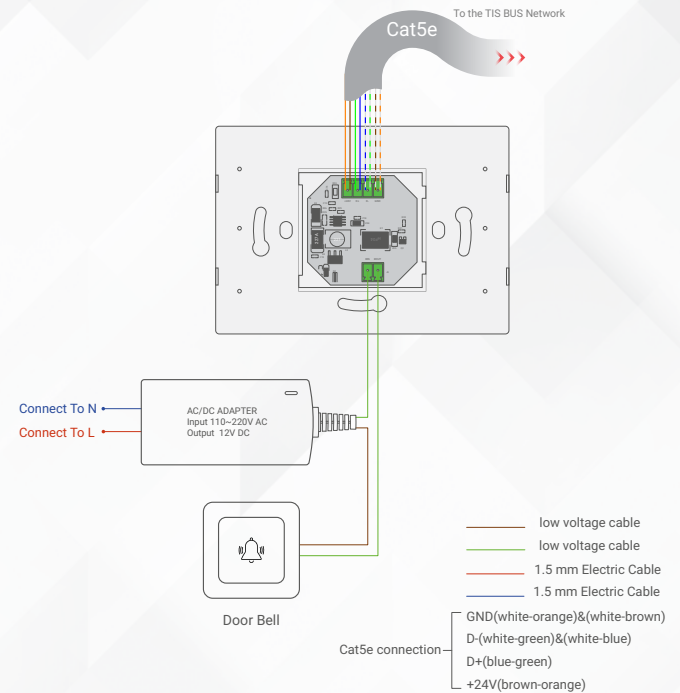

7

Mount the wall base on the wall using 2 screws on the junction box.

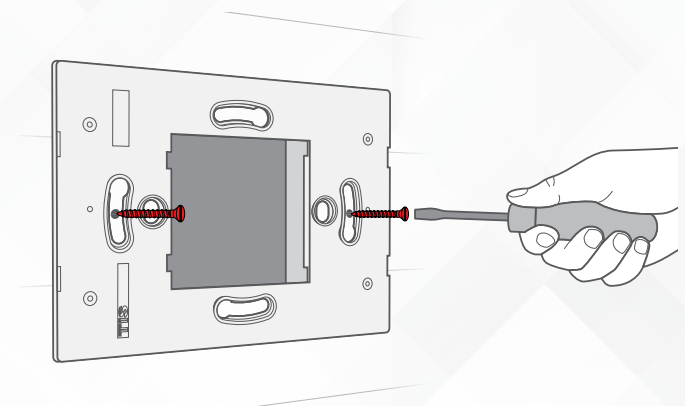



INSTALLATION STEPS

8»

Connect the main Luna panel horizontally to the base installed on the wall.

install the upper part by making sure the buckles are completely inside.

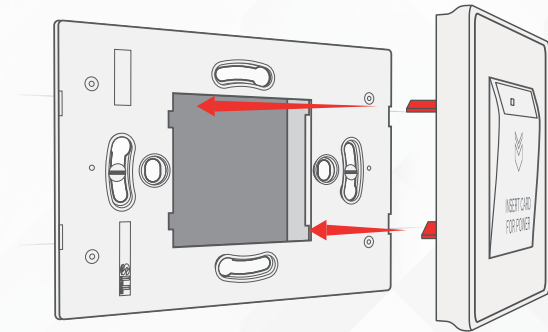

9»

Turn on the power source. The panel should turn ON.

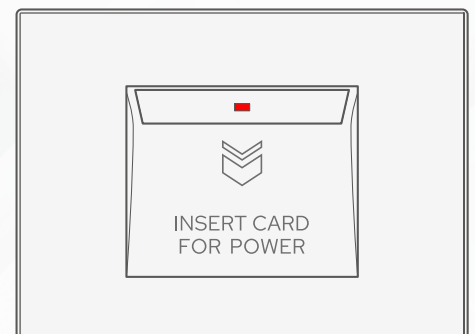

USER MANUAL

LED INDICATOR

The hotel card Led will light up if no card inserted, and will turn off if the correct card is inserted.

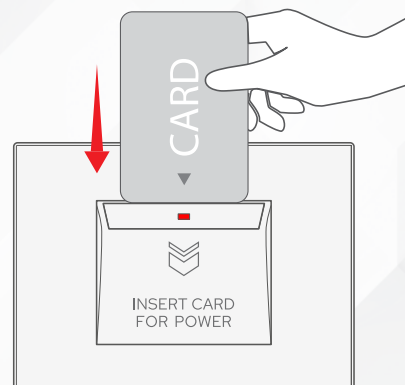

RF CARD POWER SWITCH

You can put your hotel card into this interface's slot to turn on the room's power, and pull it out to trigger the energy saving mode. The 10-seconds delayed power-off design of this switch maintains your comfort.

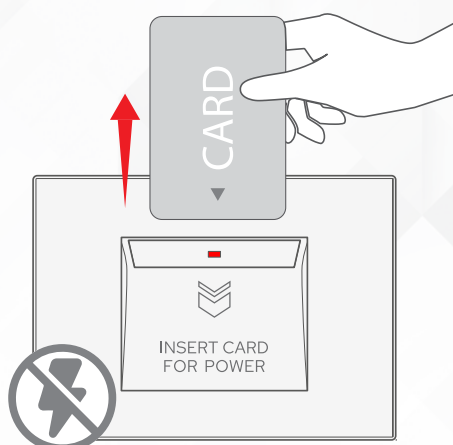
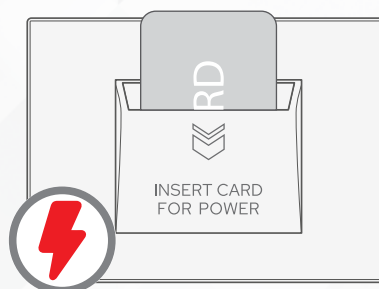



TROUBLESHOOTING



The panel buttons' LEDs do not turn ON, and the device is not powered.

Reason: The TIS 24V power supply is not connected to the TIS-BUS.



The wall panels fail to communicate with other devices.

Reason: The TIS-BUS connection has a problem, or the wire has a short.



Card inserted but the panel LED do not turn OFF.

Reason 1: Panel is programmed to accept room card only, and the card is not programmed to the same room.

Reason 2: Card's check-in date is expired.