

INSTALLATION MANUAL

LUNA HOTEL OUTDOOR BELL & SERVICE PANEL







Models: LUNA-OUT-3S-BELL, LUNA-OUT-3S-BELL-RF

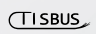

i PRODUCT INFORMATION

This product is a BUS-operated wall panel with room number and services display and a touch bell, designed for maximum convenience and efficiency in hospitality facilities.

PRODUCT SPECIFICATIONS

	Touch	Active area Touch Type	1 button for bell Capacitive
	Input	Using panel addition IF used the RF type	4 Digital inputs RF reader (Optional frequency)
	Output	Low current relay	3 Relay output 3A/5A
	TIS Bus	Number of devices on 1 line Bus voltage Current consumption	Max. 64 12-32 V DC <25 mA / 24 V DC
	Operation	touch buttons Backlight	1 touch button 3 RGB indicators + Room number white LEDs
	Functions	Bell press Access control (RF type)	Touch button RF reader with relay output
	Dimensions	Width × length × height	94mm × 129mm × 13mm
	Housing	Materials Casing color Internal parts color IP rating	Fireproof PC / Glass in front Silver plating frame. Glass black Black & White IP 50

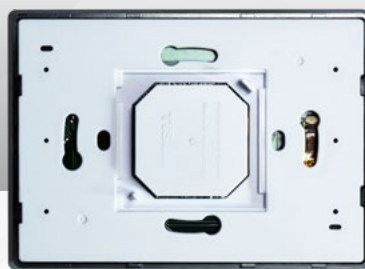



Read Instructions

We recommend that you read this Instruction Manual before installation.



Mounting Location

Install in a dry, indoor area. with a suitable temperature and humidity range.



Safety instructions

Electrical equipment should only be installed and fitted by electrically skilled persons.

Failure to follow the instructions may cause damage to the device and other hazards.

These instructions are an integral part of the product and must remain with the end customer.



Data Cable

Use screened stranded RS485 data cable with four twisted pairs. Configure devices in a "Daisy Chain."

Do not cut or terminate live data cables.



Programming

This device can be tested and programmed manually. Advanced programming requires knowledge of the TIS Device Search software and instruction in the TIS advanced training courses.



Warranty

There is a two-year warranty provided by law. The hologram warranty seal and product serial number are available on each device.



Simple Installation

You can use 2 screws to install this panel on wall; it fits on most junction box sizes.





INSTALLATION STEPS

1»

Insert a large flathead screwdriver in the hole of the Panel Cover. Rotate the screwdriver 90 degrees.

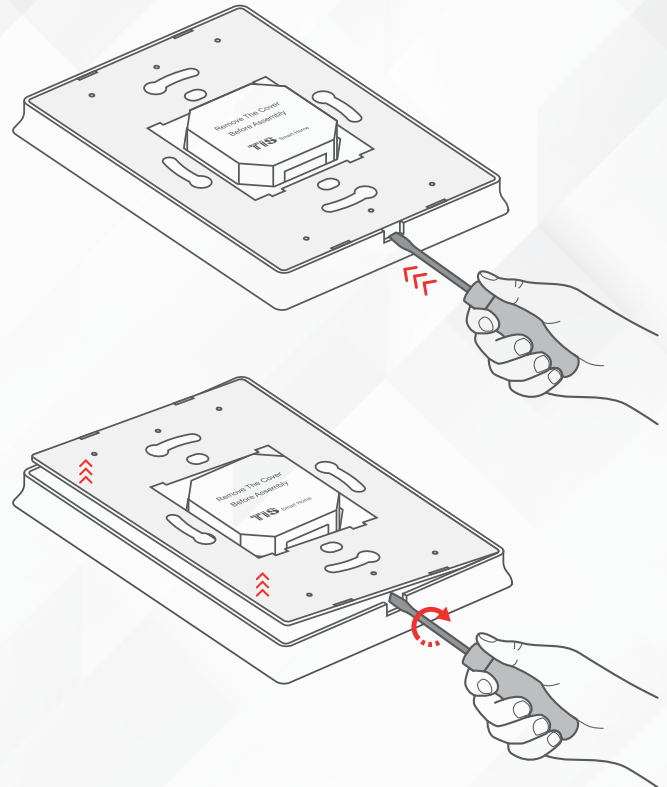

2»

Separate the Cover, Main Panel, and Wall Base from each other.

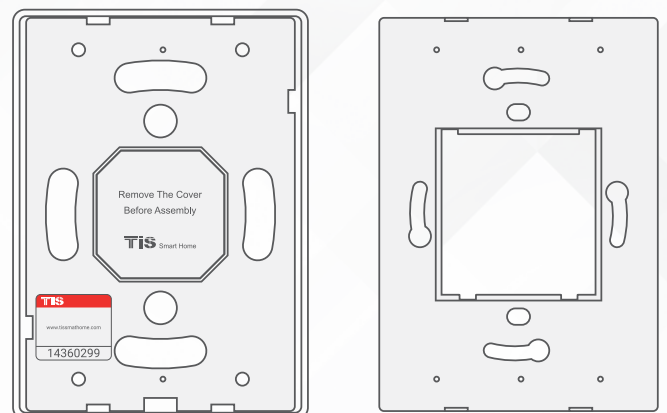



INSTALLATION STEPS

3»

Turn off the main electrical source before installation.



WARNING! HIGH VOLTAGE

4»

Connect the Cat5e TIS BUS wire to the Panel Addition.

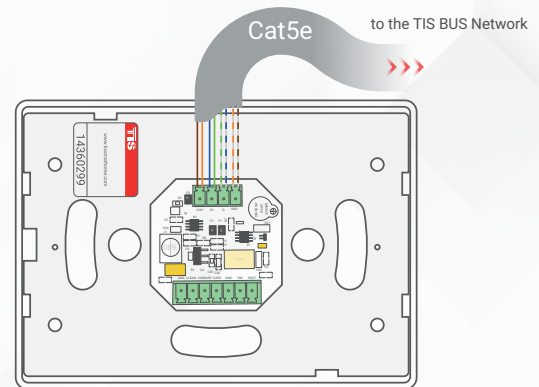

5»

Connect the other connection if needed between wall services switches to the digital inputs of the hotel panel as per the following diagram.

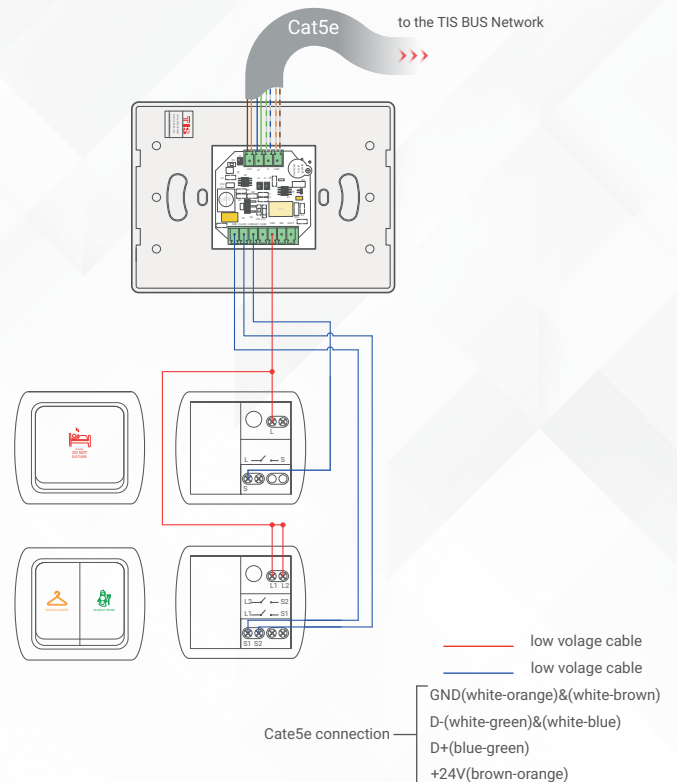



INSTALLATION STEPS

6

Connect the Door Bell to the Relay if it exists in the room.

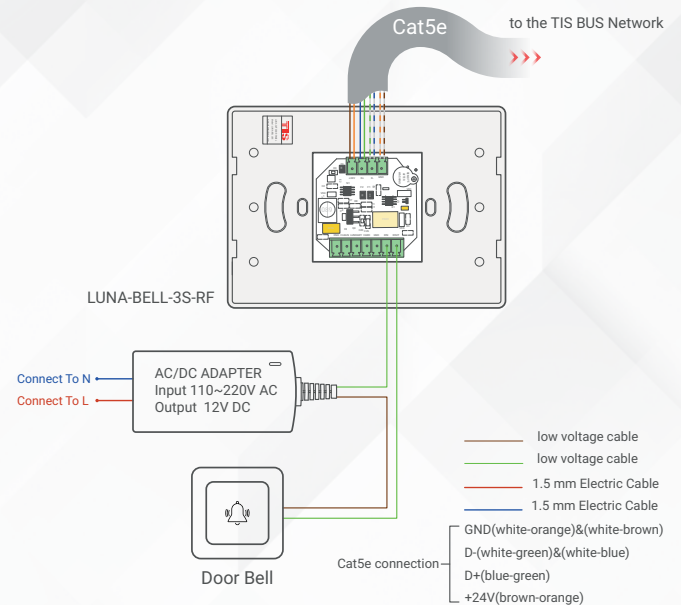

7

If you want to connect electrical lock to the RF Hotel panel type please connect it as per this diagram.

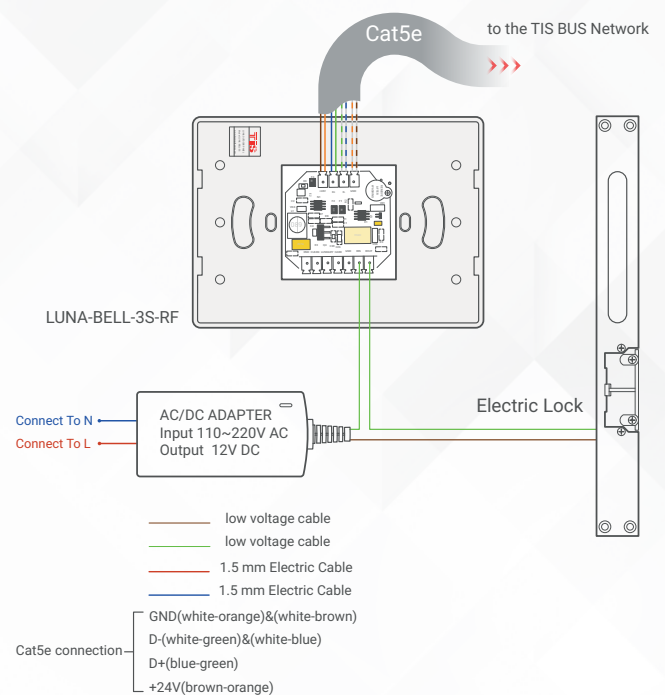



INSTALLATION STEPS

8»

Mount the device on the wall using 2 screws on the junction box.

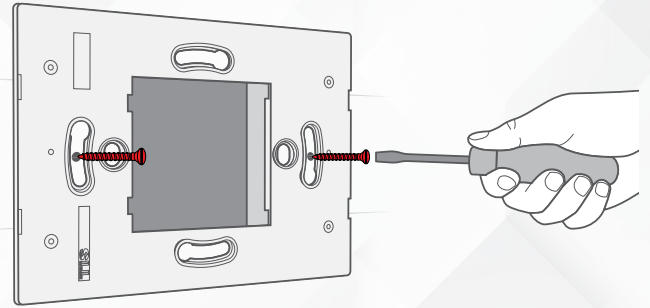

9»

Connect the main Luna panel horizontally to the part installed on the wall; install the upper part by making sure the buckles are completely inside.

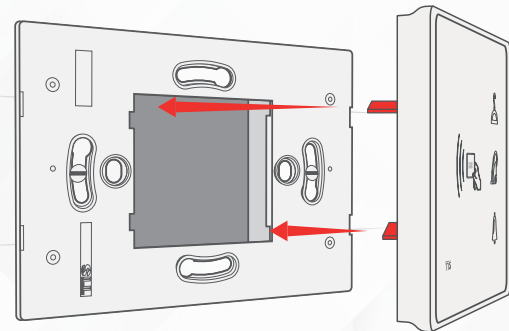

10»

Turn on the power source. The panel should turn ON.





USER MANUAL

SERVICE INDICATION AND BELL PRESS

The hotel service light will light up to indicate service request, such as Laundry, Make Up Room, or Do Not Disturb (DND). The backlit color can be set from the software.

The bell colors indicate the following:

FUNCTION	CONTROL BUTTON	
Blue (default)		Room Occupied, DND is OFF. You can press the bell, and it will ring inside the room if the bell is connected.
Red (default)		DND mode is ON; No bell function.
OFF (No backlight)		Room is vacant, so room service can start cleaning first thing in the morning, as a priority.

RF ACCESS CONTROL

If you are using the panel with the RF reading access control function, you can swipe the card near the reader position in the panel, and the door open.

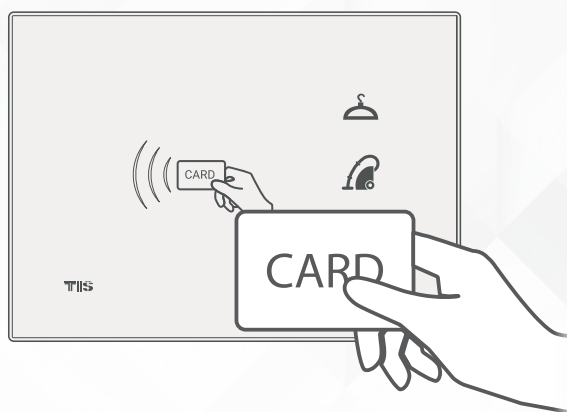



TROUBLESHOOTING



The panel buttons' LEDs do not turn ON, and the device is not powered.

Reason: The TIS 24V power supply is not connected to the TIS-BUS.



The wall panels fail to communicate with other devices.

Reason: The TIS-BUS connection has a problem, or the wire has a short.



Service LED is not turning ON/OFF.

Reason 1: When programming, you did not set the right message or address.

Reason 2: ON status color is set to black in the software.