

# INSTALLATION MANUAL

## TIS TERRE PANEL

Touch AC Switch

Model: TER-ACT

**TIS**  
CONTROL EVERYTHING

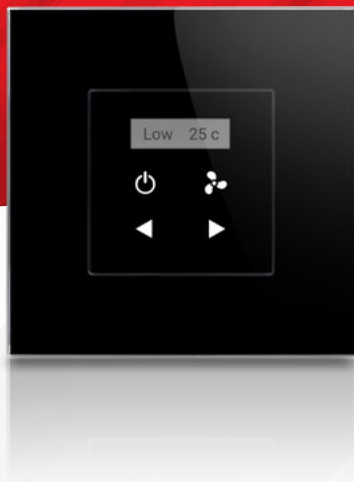

### **PRODUCT INFORMATION**

This product is a wall switch with touch buttons designed for room temperature control. It offers customizable backlit color and frame covers for an easy combination with interior schemes.

#### PRODUCT SPECIFICATIONS

	<b>OLED</b>	Size	0.9"
	<b>Touch</b>	Active area Touch type	1.5" Capacitive
	<b>Input</b>	Temp sensor	Resistive temp sensor
	<b>TIS Bus</b>	Number of devices on 1 line Bus voltage Current consumption	Max. 64 12-32 V DC <20 mA / 24 V DC
	<b>Protection</b>		Reverse polarity protection ESD protection
	<b>Operation</b>	Touch buttons Backlit TIS bus Upgrading	4 control buttons LED indicators TIS Protocol messages and commands By Rs485 upgrading kit
	<b>Dimensions</b>	Width × length × height	25mm × 45mm × 45mm
	<b>Housing</b>	Materials Internal Parts color IP rating	Fireproof PC / Glass in front Black & Gray IP 50

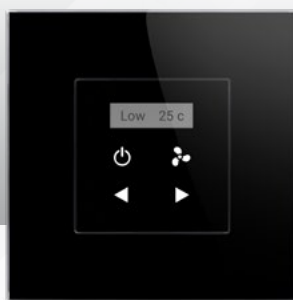

BARCODE (UPC-A)





### Read Instructions

We recommend that you read this Instruction Manual before installation.



### Data Cable

Use screened stranded RS485 data cable with four twisted pairs. Configure devices in a "Daisy Chain."

**Do not cut or terminate live data cables.**



### Safety instructions

Electrical equipment should only be installed and fitted by electrically skilled persons.

Failure to follow the instructions may cause damage to the device and other hazards.

These instructions are an integral part of the product and must remain with the end customer.



### Electrical Wires

The recommended wire size for light channels is 1.5mm - 2.5mm for loads, if you are using the Panel Addition 3R type. The installer should consider the total current consumption when selecting the wires.



### Programming

This device can be tested and programmed manually. Advanced programming requires knowledge of the TIS Device Search software and instruction in the TIS advanced training courses.



### Warranty

There is a two-year warranty provided by law. The hologram warranty seal and product serial number are available on each device.



### Simple Installation

You can use 2 screws to install this panel on wall; it fits on Europe round and UK square junction box sizes.



### Mounting Location

Install in a dry, indoor area with a suitable temperature and humidity range.

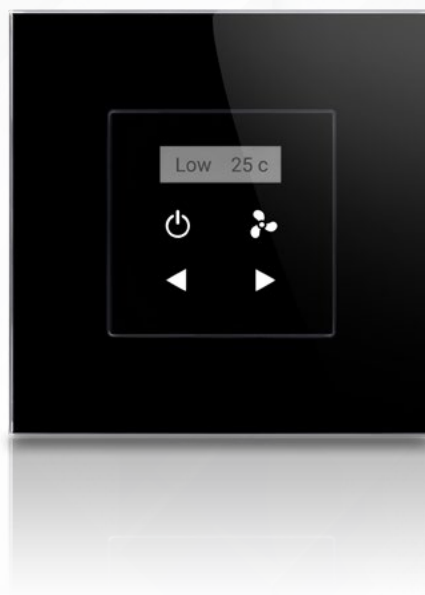



## INSTALLATION STEPS



The TIS Terre wall switch consists of three main components for installation; a base module unit (fig. 1), a wall base (fig 2), and a top interface cover (fig 3).

The top cover comes in a variety of materials, colors, and a customized combination of 1-4 gangs.

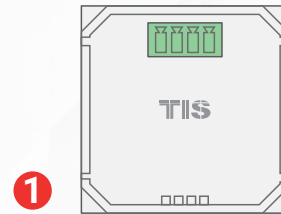

2

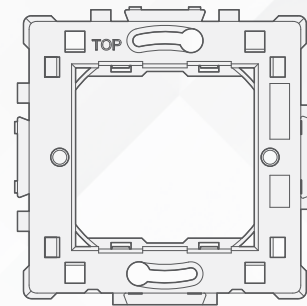

3

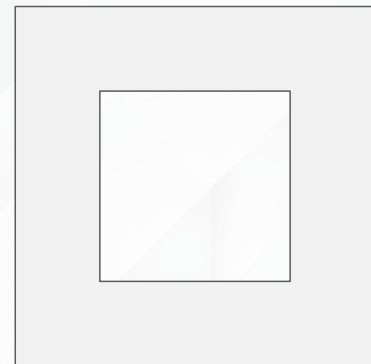

1 Turn off TIS power supply.



**WARNING! HIGH VOLTAGE**



## INSTALLATION STEPS

2»

Insert the Terre Module inside the Terre Base by pushing it inside. Please note the “TOP” label on the base in order to insert the module correctly.

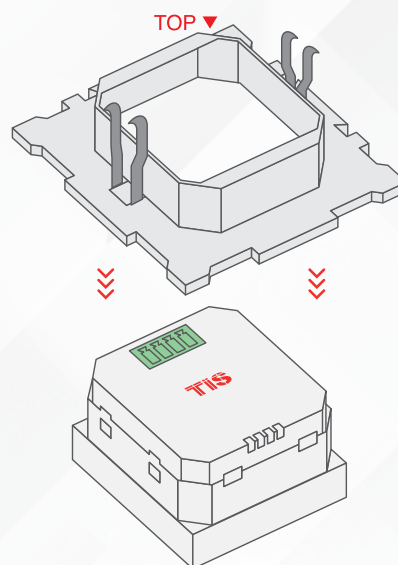
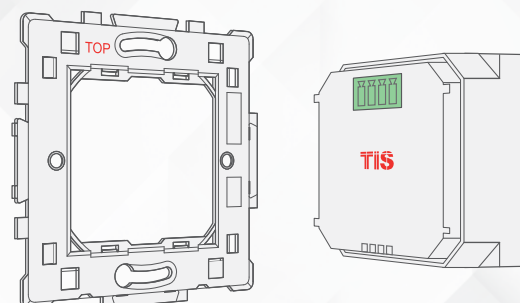

3»

Connect the TIS-BUS Cable to the connector, and insert it into the Terre module.

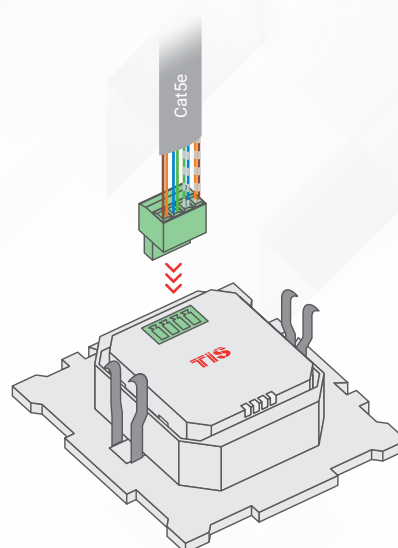



## INSTALLATION STEPS

4»

Install the Terre base into the wall, and fix it with 2 screws.

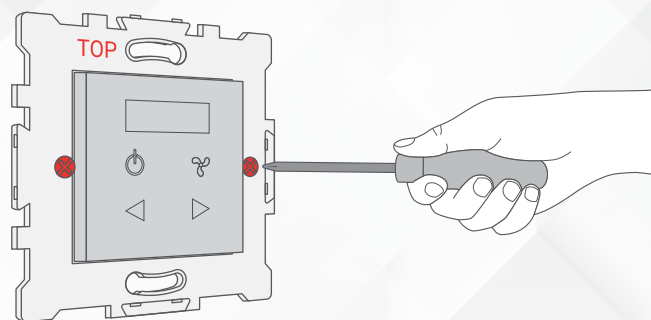

5»

Install the Terre cover on the Terre base.

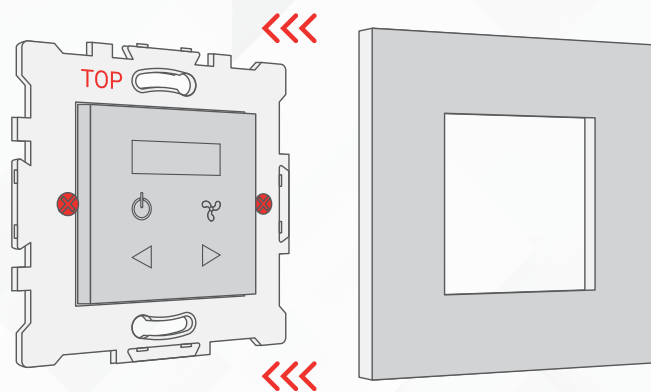

6»

Turn the power supply ON. The Terre panel should turn on.

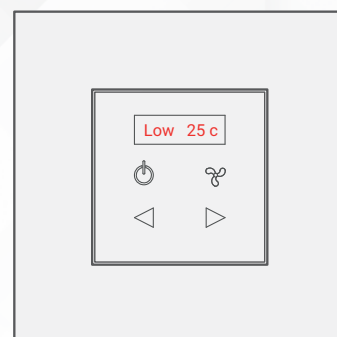



## INSTALLATION STEPS



The Terre series is modular, so you can combine 2 to 4 different Terre panels, switches, or plugs together vertically or horizontally. To do so, follow these steps:

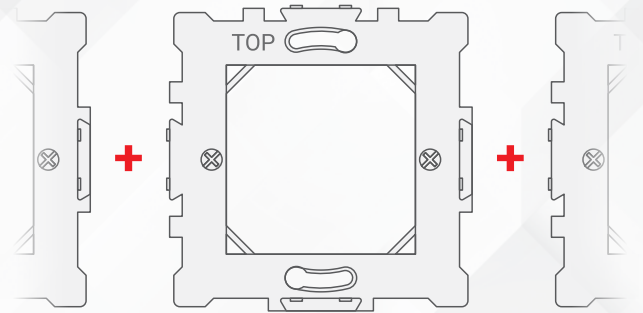

**1** ➤

Combine 2, 3, or 4 bases together horizontally or vertically. Please note that all “TOP” labels should always be in the correct position.

- ▶ The following picture shows how to install 2 bases horizontally.

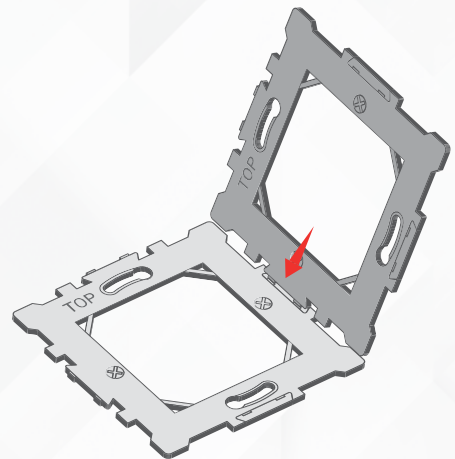

- ▶ The following picture shows how to install 2 bases vertically.

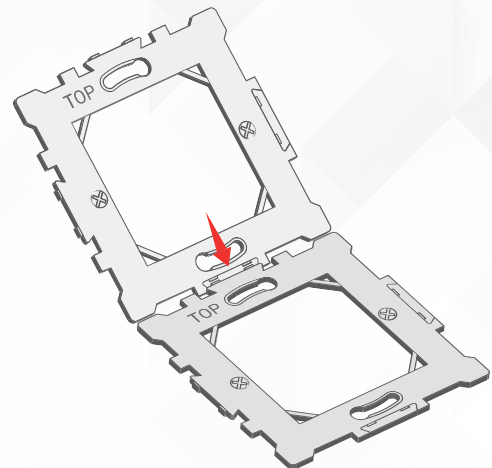





## INSTALLATION STEPS

2»

Insert the Terre panels, switches, or plugs into the base.

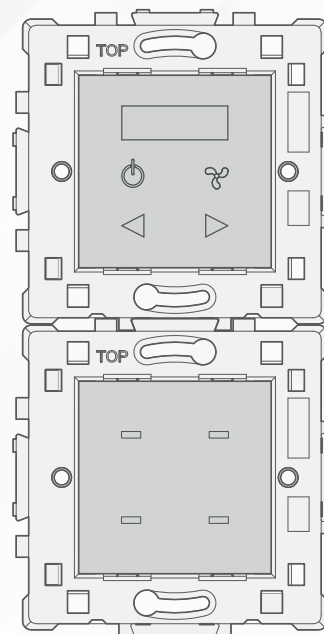

3»

Cover with the Terre 2-, 3-, or 4-gang covers according to the combination.

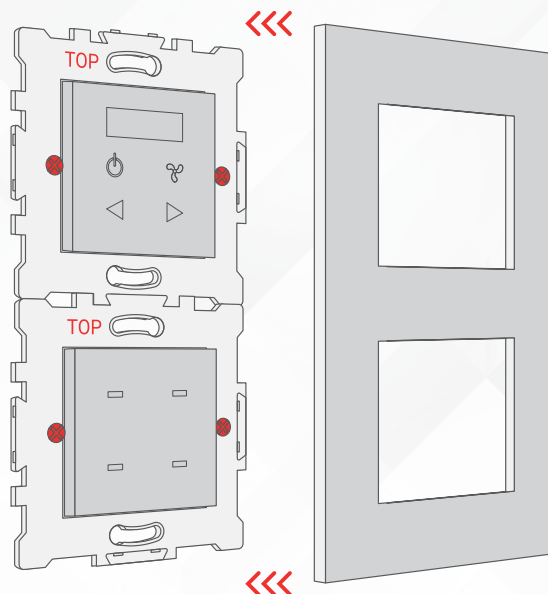



## INSTALLATION STEPS



To use the Terre with Panel Addition, you should select Model TER-ACT-A and follow these steps:

**1** 

Remove the back Terre part.

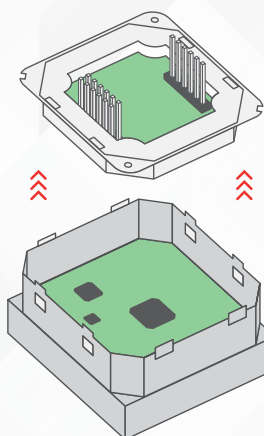
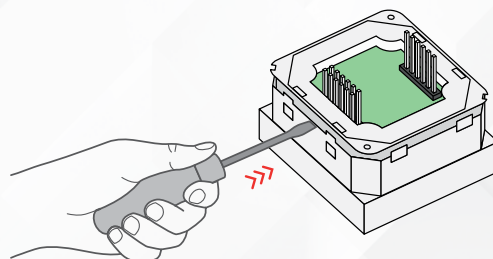

**2** 

Insert the Terre panel into the Terre base.

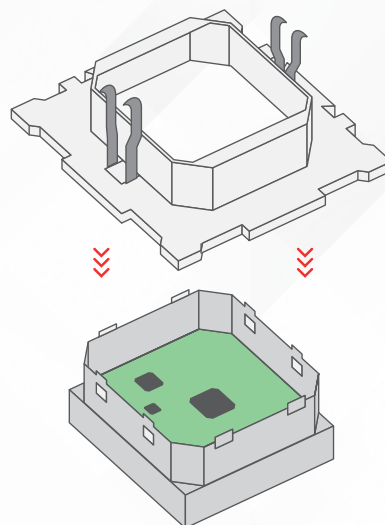





## INSTALLATION STEPS

3»

Connect the back part to the panel again.

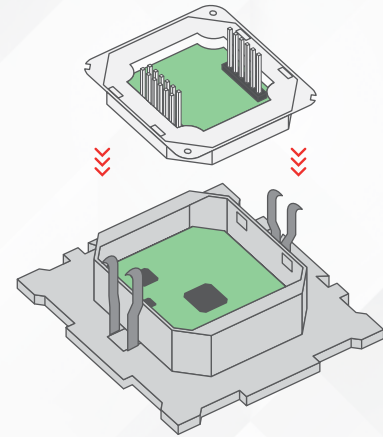

4»

Connect any panel addition type that supports the Terre panel.

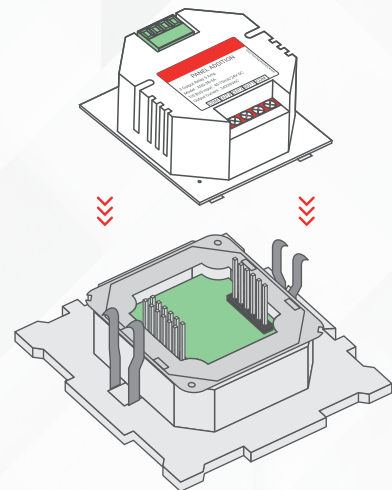

5»

Follow the connection diagram as per the type of panel addition.

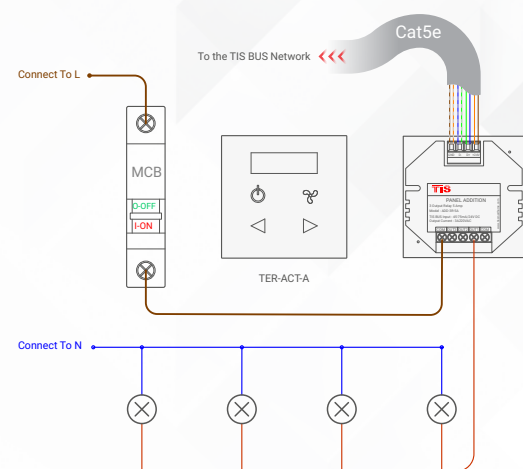



## INSTALLATION STEPS

6»

Install the Terre base into the wall, and fix it with 2 screws.

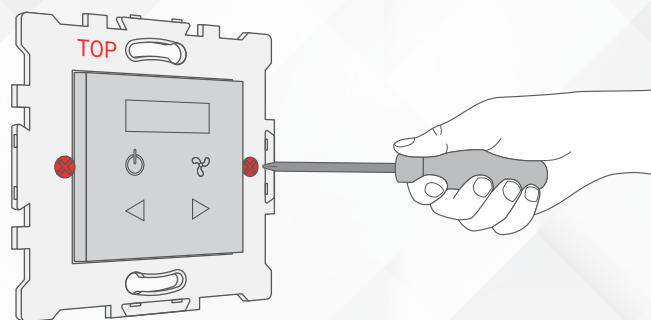

7»

Install the Terre cover on the Terre base.

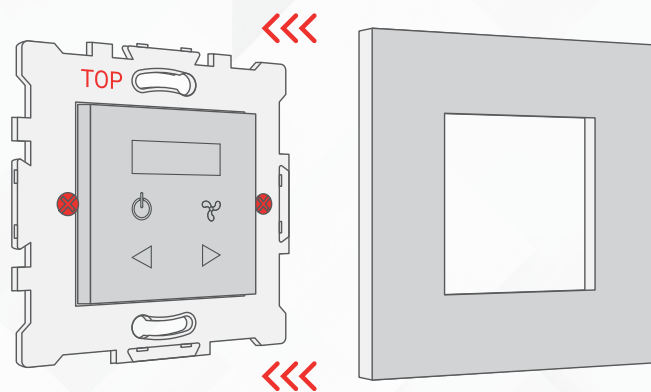

8»

Turn the power supply ON. The Terre panel should turn on.

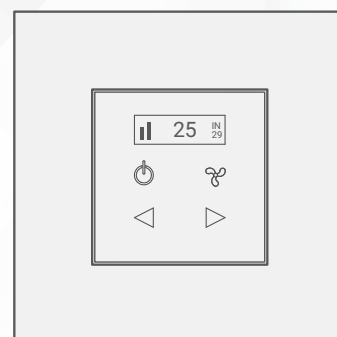

## PAIRING (MANUAL PROGRAMMING)

## FCU PROGRAMMING

- 1» To program the FCU to any wall thermostat panel, press and hold the first Channel L (LOW) button for 6 seconds. The LED indicator of the pressed button will start blinking,

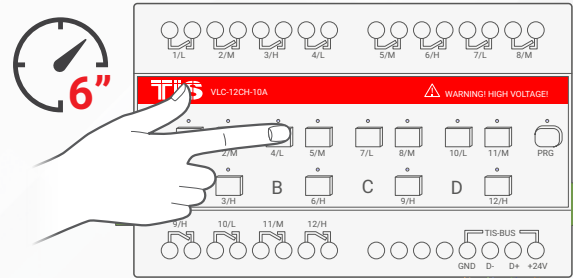

- 2» On the Terre panel, turn the AC ON.

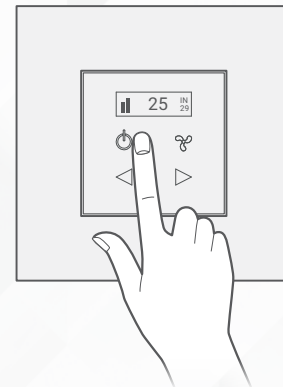

- 3» Test your air conditioning by changing the fan speed from low to medium to high. Your relay should respond accordingly.

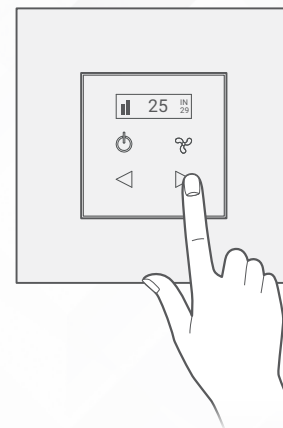

## PAIRING (MANUAL PROGRAMMING)

### HVAC PROGRAMMING

**1** Press the PRG button of the HVAC Module for 6 seconds until the green LED turns on and is steady.

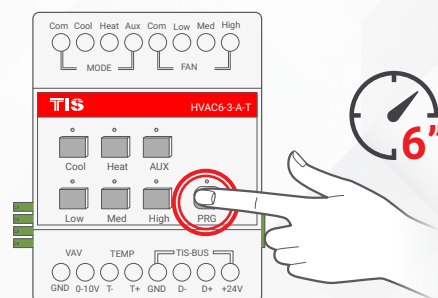

**2** On Terre panel, turn the AC ON.

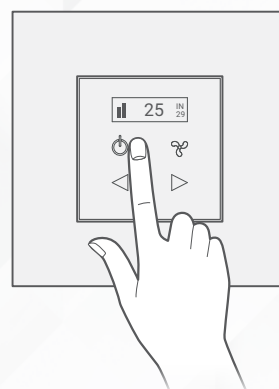

**3** Test your air conditioning by changing the mood, Heat/Cool, and fan speed from low to medium to high. HVAC module should respond accordingly.

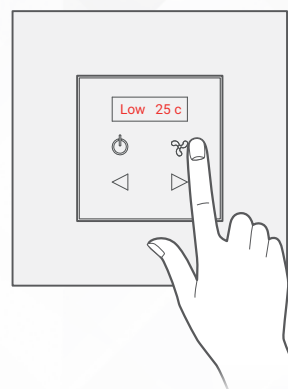

## PAIRING (MANUAL PROGRAMMING)

### FLOOR HEATING PROGRAMMING

- 1  Press any button on any channel of a relay or dimmer module for 6 seconds so that the LED indicator light of that button starts blinking.

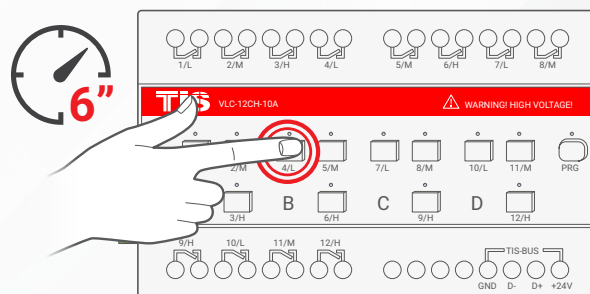

- 2  On Terre floor heater page, turn the floor heating ON. (see page 14)

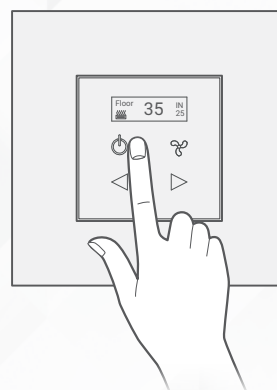

- 3  Test your floor heating by changing the temperature, relay should respond accordingly.

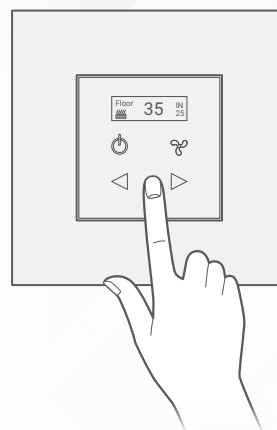



## USER MANUAL





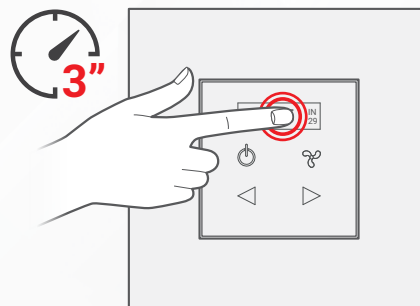

## SHIFTING BETWEEN AC & FLOOR HEATING PAGE

To change between the AC page and the floor heater page, press and hold the OLED screen for 3 seconds.



## CONTROLLING AIR CONDITIONING

FUNCTION	CONTROL BUTTON	
Turn AC ON/OFF		Press the AC Power button to turn AC ON/OFF.
Increase Temperature		Press the right arrow button to increase temperature one degree.
Decrease Temperature		Press the left arrow button to decrease the temperature one degree.
Change Fan Speed		Press the fan button to change the speed between low, med, high, and auto.
Change AC Mood		Long press the fan button for 6 seconds until the mood is shown on the screen. Then, change the mood to cool, heat, fan, or auto by short pressing on the up and down arrow buttons. Once you select your mood, do not press any button for 5 seconds or until the main screen display returns.







## USER MANUAL



## CONTROLLING FLOOR HEATING

FUNCTION	CONTROL BUTTON	
Turn Floor Heating ON/OFF		Press the AC Power button to turn AC ON/OFF.
Increase Temperature		Press the right arrow button to increase temperature one degree.
Decrease Temperature		Press the left arrow button to decrease the temperature one degree.



## TROUBLESHOOTING



**The panel's button LED blinks rapidly.**

**Reason:** The panel address conflicts with another device in the TIS network. You need to press and hold the left area on the OLED for 6 seconds so that the panel can get a new address.



**Problem: The panel buttons' LEDs do not turn ON, and the device is not powered.**

**Reason 1:** There is no TIS-BUS power or no connection to the L/N input (if used AIR bus-3W converter).

**Reason 2:** The TIS 24V power supply is not connected to the TIS-BUS.



**The wall panels fail to pair with other devices.**

**Reason 1:** The TIS-BUS connection has a problem, or the wire has a short.

**Reason 2:** The manual programming function is disabled on the device (it is enabled by default).



**The wall panels fail to control the device channels.**

**Reason 1:** The TIS-BUS connection has a problem, or the wire has a short.

**Reason 2:** The programming address is faulty.



**Panel showing wrong temperature above 100°C**

**Reason:** The panel temperature sensor is not connected correctly.