

# INSTALLATION MANUAL

## TIS TERRE PANEL

Touch Music Switch

Model: TER-AUD







**TIS**  
CONTROL EVERYTHING

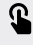

### PRODUCT INFORMATION

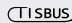
This product is a wall switch with touch buttons designed for music play and control. It offers customizable backlit color and frame covers for an easy combination with interior schemes.

### PRODUCT SPECIFICATIONS

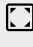
|   |                   |   |   |
|---|-------------------|---|---|
|    | <b>OLED</b>       | Size  | 0.9"  |
|   | <b>Touch</b>      | Active area<br>Touch type   | 1.5"<br>Capacitive  |
|  | <b>Input</b>      | Temp sensor   | Resistive temp sensor   |
|  | <b>TIS Bus</b>    | Number of devices on 1 line<br>Bus voltage<br>Current consumption | Max. 64<br>12-32 V DC<br><20 mA / 24 V DC   |
|  | <b>Protection</b> |   | Reverse polarity protection<br>ESD protection   |
|  | <b>Operation</b>  | Touch buttons<br>Backlit<br>TIS bus<br>Upgrading                  | 8 control buttons<br>LED indicators<br>TIS protocol messages and commands<br>By Rs485 upgrading kit |
|  | <b>Dimensions</b> | Width × length × height   | 25mm × 45mm × 45mm  |
|  | <b>Housing</b>    | Materials<br>Internal parts color<br>IP rating                    | Fireproof PC / Glass in front<br>Black / gray<br>IP 50  |

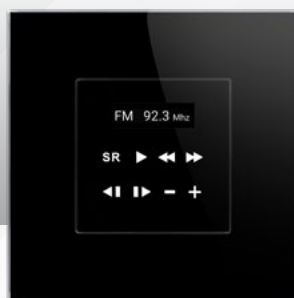

BARCODE (UPC-A)





### Read Instructions

We recommend that you read this Instruction Manual before installation.



### Data Cable

Use screened stranded RS485 data cable with four twisted pairs. Configure devices in a "Daisy Chain."

**Do not cut or terminate live data cables.**



### Safety instructions

Electrical equipment should only be installed and fitted by electrically skilled persons.

Failure to follow the instructions may cause damage to the device and other hazards.

These instructions are an integral part of the product and must remain with the end customer.



### Electrical Wires

The recommended wire size for light channels is 1.5mm - 2.5mm for loads, if you are using the Panel Addition 3R type. The installer should consider the total current consumption when selecting the wires.



### Programming

This device can be tested and programmed manually. Advanced programming requires knowledge of the TIS Device Search software and instruction in the TIS advanced training courses.



### Warranty

There is a two-year warranty provided by law. The hologram warranty seal and product serial number are available on each device.



### Simple Installation

You can use 2 screws to install this panel on wall; it fits on Europe round and UK square junction box sizes.



### Mounting Location

Install in a dry, indoor area with a suitable temperature and humidity range.





## INSTALLATION STEPS



The TIS Terre wall switch consists of three main components for installation; a base module unit (fig. 1), a wall base (fig 2), and a top interface cover (fig 3).

The top cover comes in a variety of materials, colors, and a customized combination of 1-4 gangs.

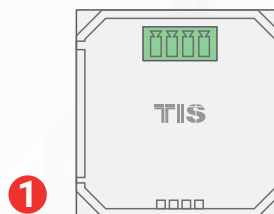

1

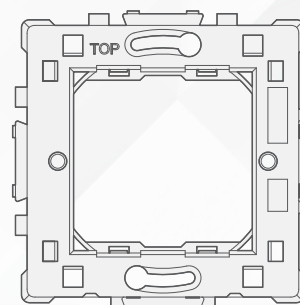

2

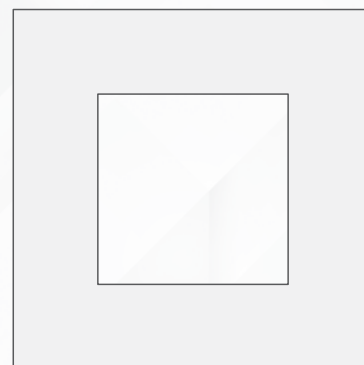

3



Turn off TIS power supply.



**WARNING! HIGH VOLTAGE**



## INSTALLATION STEPS

2»

Insert the Terre Module inside the Terre Base by pushing it inside. Please note the "TOP" label on the base in order to insert the module correctly.

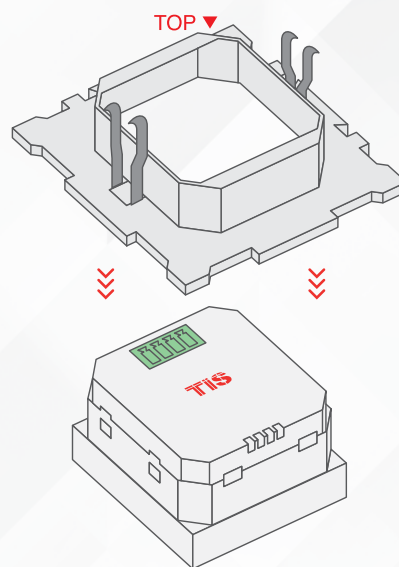
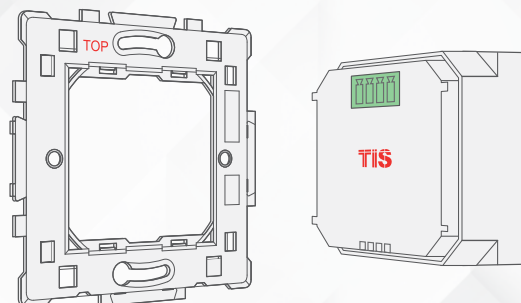

3»

Connect the TIS-BUS Cable to the connector, and insert it into the Terre module.

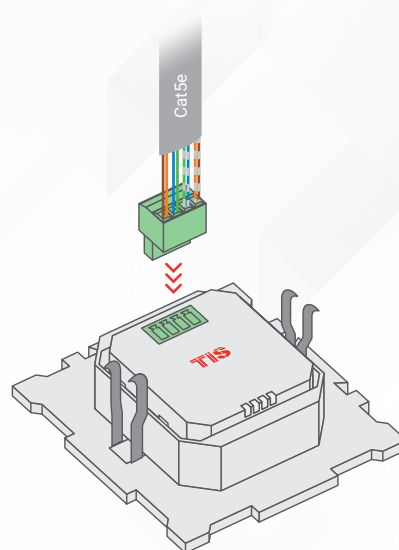



## INSTALLATION STEPS

4»

Install the Terre base into the wall, and fix it with 2 screws.

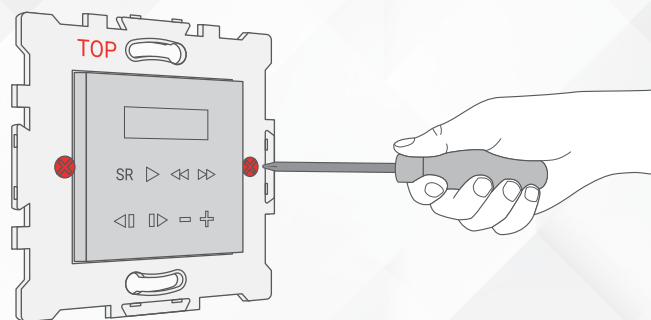

5»

Install the Terre cover on the Terre base.

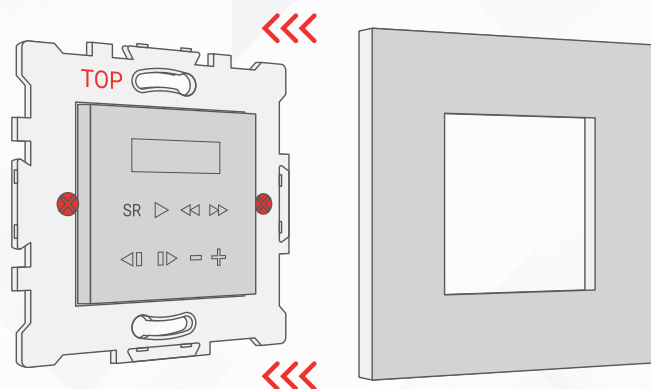

6»

Turn the power supply ON. The Terre panel should turn on.

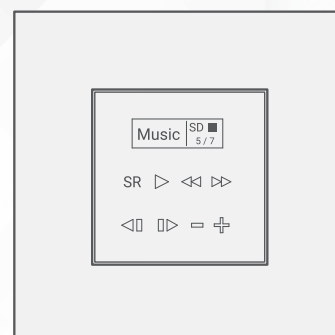



## INSTALLATION STEPS



The Terre series is modular, so you can combine 2 to 4 different Terre panels, switches, or plugs together vertically or horizontally. To do so, follow these steps:

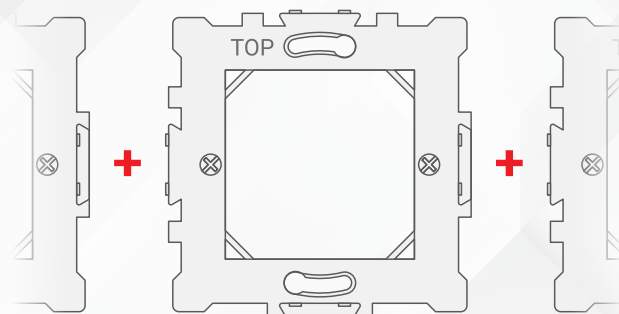

1

Combine 2, 3, or 4 bases together horizontally or vertically. Please note that all “TOP” labels should always be in the correct position.

- ▶ The following picture shows how to install 2 bases horizontally.

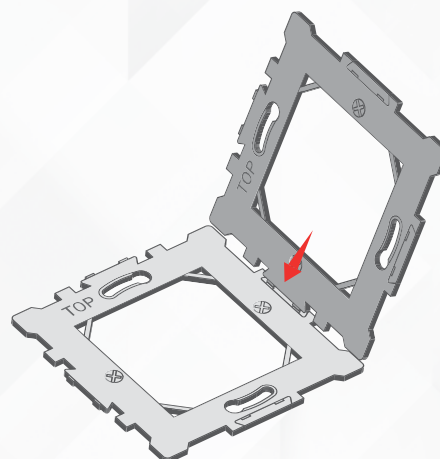

- ▶ The following picture shows how to install 2 bases vertically.

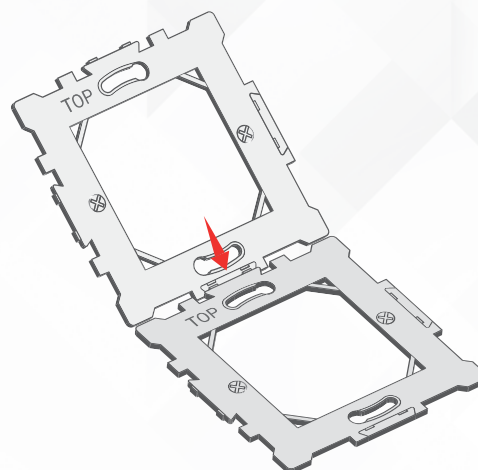





## INSTALLATION STEPS

2»

Insert the Terre panels, switches, or plugs into the base.

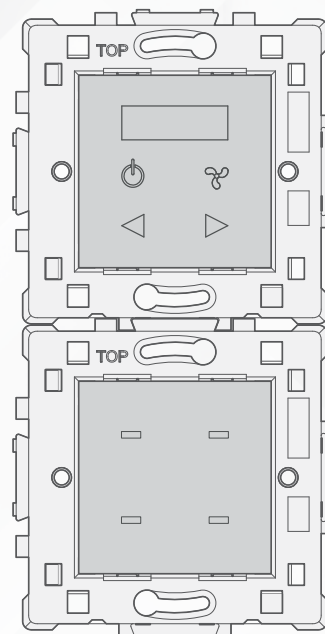

3»

Cover with the Terre 2-, 3-, or 4-gang covers according to the combination.

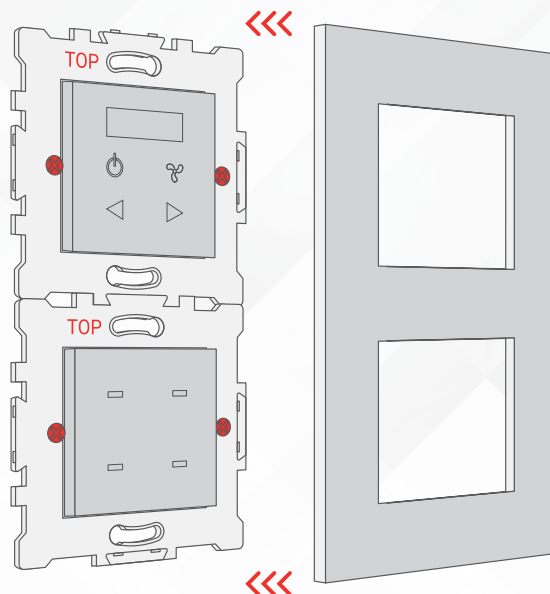



## INSTALLATION STEPS



To use the Terre with Panel Addition, you should select Model TER-AUD-A and follow these steps:

1 >>

Remove the back Terre part.

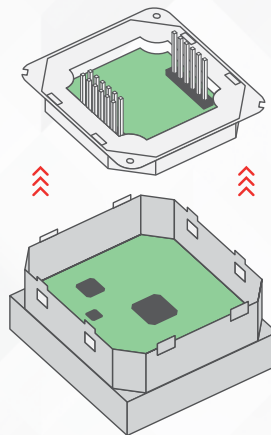
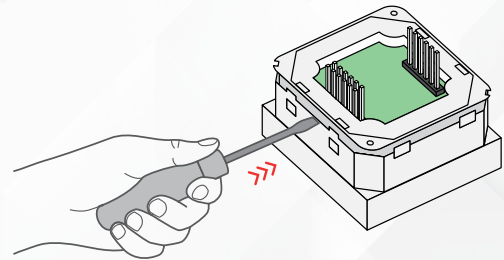

2 >>

Insert the Terre panel into the Terre base.

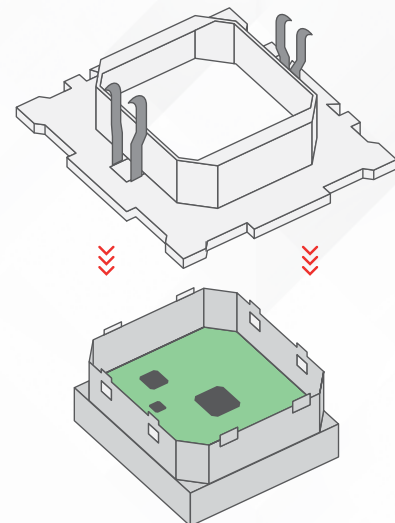





## INSTALLATION STEPS

3»

Connect the back part to the panel again.

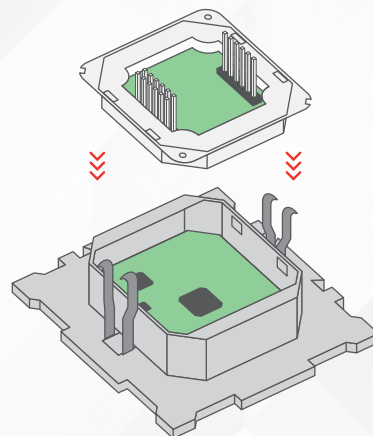

4»

Connect any panel addition type that supports the Terre panel.

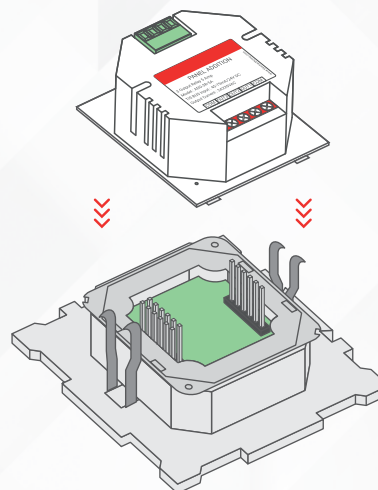

5»

Follow the connection diagram as per the type of panel addition.

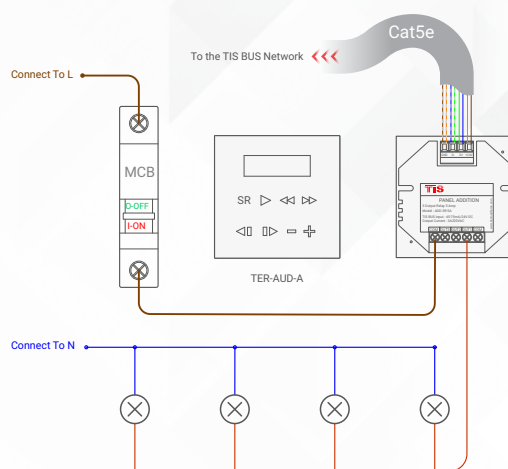



## INSTALLATION STEPS

6

Install the Terre base into the wall, and fix it with 2 screws.

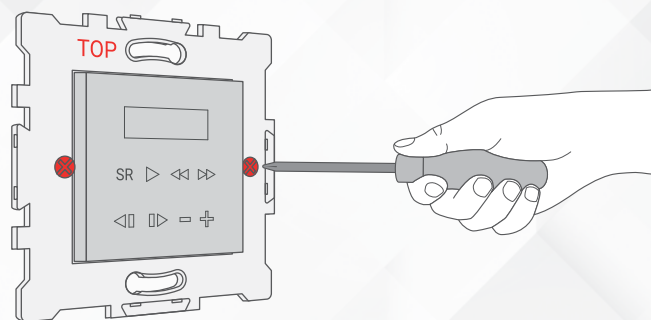

7

Install the Terre cover on the Terre base.

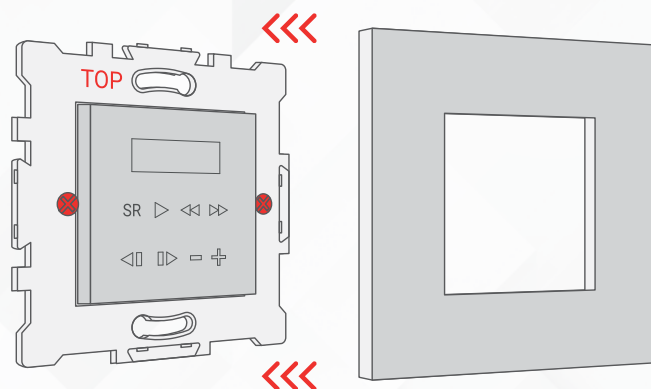

8

Turn the power supply ON. The Terre panel should turn on.

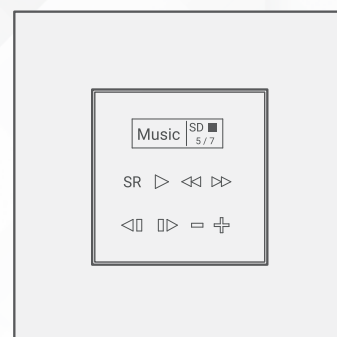

## PAIRING (MANUAL PROGRAMMING)

### MUSIC PROGRAMMING

**1** Long press the PRG buttons on the Audio Matrix for 8 seconds. The PRG LED indicator will start blinking.

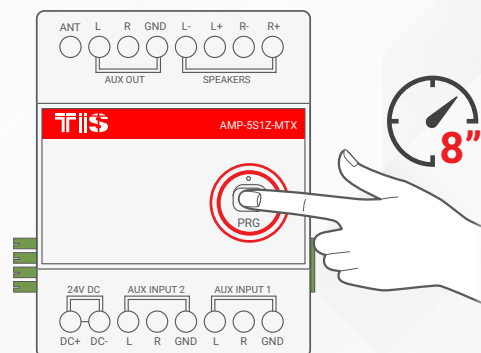

**2** On the Terre Panel, press the play button.

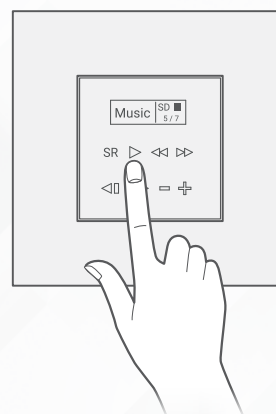

**3** Wait a few seconds and then try to play the source; the amplifier should react to the panel commands.

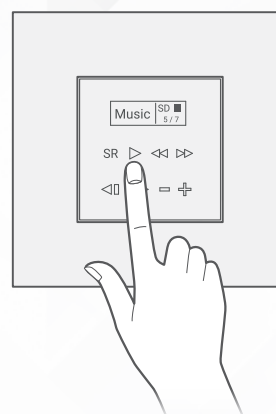



## USER MANUAL



## USING THE PANEL

| FUNCTION                            | CONTROL BUTTON |  |
|-------------------------------------|----------------|--|
| Select the Source                   | SR             | Press SR to shift the source between SD/USB/FM Radio/Aux1/Aux2.  |
| Play / Pause Track                  | ▶              | Press the Play button to play. Press again to pause.   |
| Next Track / Radio frequency        | ▶▶             | Press the Next icon to go to the next track if your source is set to SD/USB, or change the frequency if your source is set to Radio.                   |
| Previous Track / Radio frequency    | ◀◀             | Press the Previous icon to go to the previous track if your source is set to SD/USB, or change the frequency if your source is set to Radio.           |
| Next Album / Next Radio Channel     | ▶▶▶            | Press the Shift Forward icon to go to the next album if your source is set to SD/USB, or change the Radio Channel your source is set to Radio.         |
| Previous Album / Next Radio Channel | ◀◀◀            | Press the Shift Previous icon to go to the previous album if your source is set to SD/USB, or change the Radio Channel if your source is set to Radio. |
| Reduce Volume                       | —              | Press the “-” icon to reduce the volume.   |
| Increase Volume                     | +              | Press the “+” icon to increase the volume.   |



## TROUBLESHOOTING



**The panel's button LED blinks rapidly.**

**Reason:** The panel address conflicts with another device in the TIS network. You need to press and hold the left area on the OLED for 6 seconds so that the panel can get a new address.



**The panel buttons' LEDs do not turn ON, and the device is not powered.**

**Reason 1:** There is no TIS-BUS power or no connection to the L/N input (if used AIR bus-3W converter).

**Reason 2:** The TIS 24V power supply is not connected to the TIS-BUS.



**The wall panels fail to pair with other devices.**

**Reason 1:** The TIS-BUS connection has a problem, or the wire has a short.

**Reason 2:** The manual programming function is disabled on the device (it is enabled by default).



**The wall panels fail to control the device channels.**

**Reason 1:** The TIS-BUS connection has a problem, or the wire has a short.

**Reason 2:** The programming address is faulty.