

# INSTALLATION MANUAL

## TIS CLICK THERMOSTAT PANEL

Modular Wall Thermostat

Model: TIS-CLK-AC-XXX







**TIS**  
CONTROL EVERYTHING



### PRODUCT INFORMATION

The Click AC is a stylish and versatile air conditioning controller with a modular design, available in black, white, or gray to seamlessly match your space. Equipped with a 1.5-inch LCD screen, it offers clear and intuitive display of settings.

### PRODUCT SPECIFICATIONS

	<b>Input</b>	Temperature Sensor	0-100C
	<b>TIS Bus</b>	Number of devices on 1 line Bus voltage Current consumption	Max. 64 12-32 V DC <50 mA / 24 V DC
	<b>Operating and display elements</b>	Display 4 push buttons TIS bus	1.5 inch LCD Screen 4 push buttons for AC finction TIS Protocol messages and commands
	<b>Functions</b>	POWER Button Arrow UP / Down Fan/Mode	AC ON-OFF Change Temperature / Change Fan speed, Cool heat fan mode
	<b>Dimensions</b>	Width x length x height	51.7mmx51.7mmx32.5mm
	<b>Housing</b>	Materials Internal Parts color IP rating	PC anti fire Black, Gray, White, Or Gold IP 50



BARCODE (UPC-A)



6 06795 20678 0





### Read Instructions

We recommend that you read this Instruction Manual before installation.



### Data Cable

Use screened stranded RS485 data cable with four twisted pairs. Configure devices in a "Daisy Chain."

**Do not cut or terminate live data cables.**



### Safety instructions

Electrical equipment should only be installed and fitted by electrically skilled persons.

Failure to follow the instructions may cause damage to the device and other hazards.

These instructions are an integral part of the product and must remain with the end customer.



### Warranty

There is a two-year warranty provided by law. The hologram warranty seal and product serial number are available on each device.



### Programming

This device can be tested and programmed manually. Advanced programming requires knowledge of the TIS Device Search software and instruction in the TIS advanced training courses.



### Simple Installation

You can use 2 screws to install this panel on the wall; it fits European round and UK square junction box sizes.



### Mounting Location

Install in a dry, indoor area with a suitable temperature and humidity range.





## INSTALLATION STEPS



The TIS Click thermostat panel consists of two main parts: a base module and a top interface cover. The cover is available in black, gray, white and gold. Attach the chosen cover to the modular frame.



1 Turn off the TIS power supply



**WARNING! HIGH VOLTAGE**



2 Screw the junction box

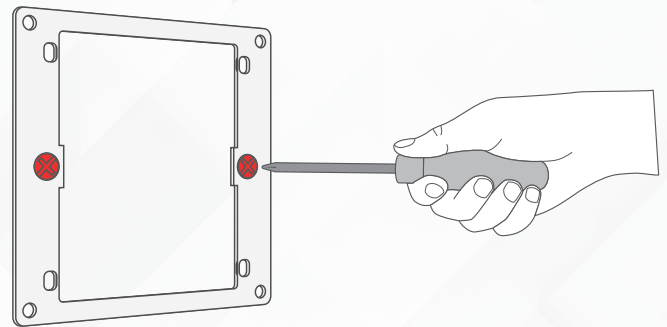

3 Connect the TIS-Bus Cable and insert it into the module

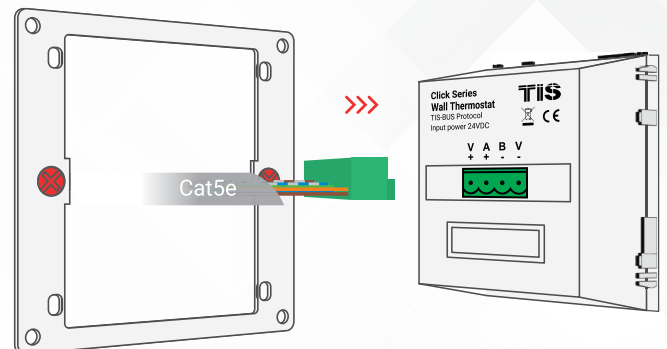



## INSTALLATION STEPS

4

Push the Click Module into the base

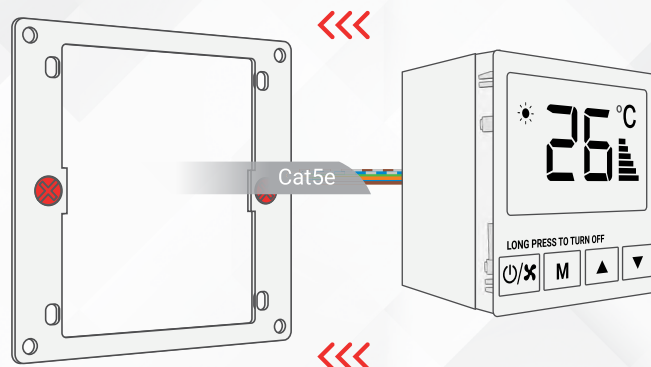

5

Attach the cover onto the base

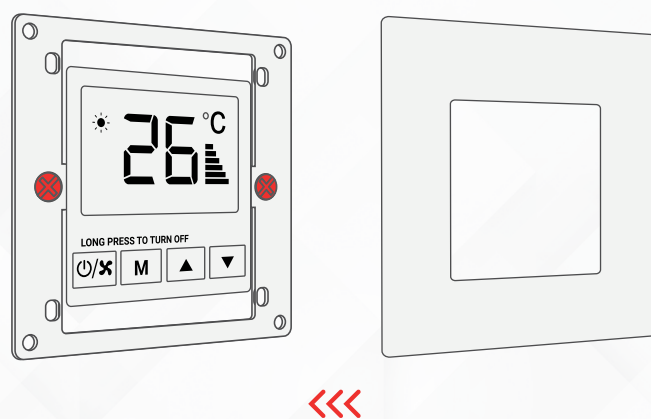

6

Turn on the power; the Click thermostat panel should activate

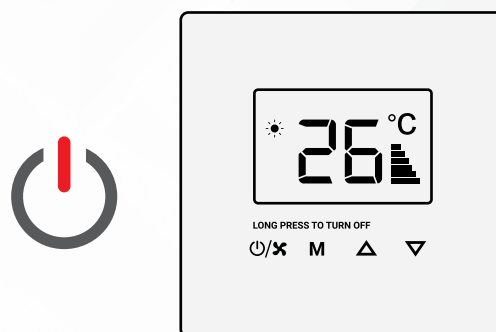

### PAIRING (MANUAL PROGRAMMING)

To pair the module to wall panel (thermostat) complete the following steps manually:

- 1  Press the PRG button for 6 seconds until the green LED steady turns on

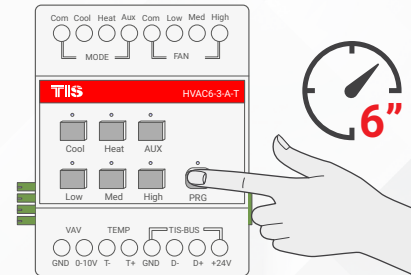

- 2  Go to the Air Conditioning page in your Click thermostat panel, and turn the AC ON

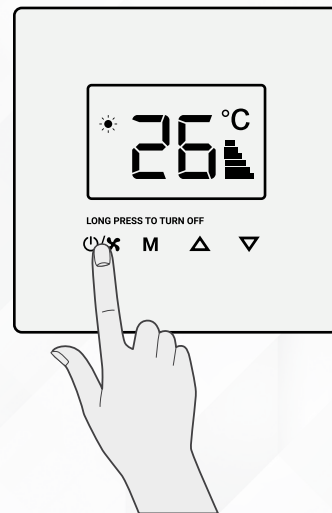

- 3  Test your air conditioning by changing the fan speed from low to medium to high. HVAC module should respond accordingly

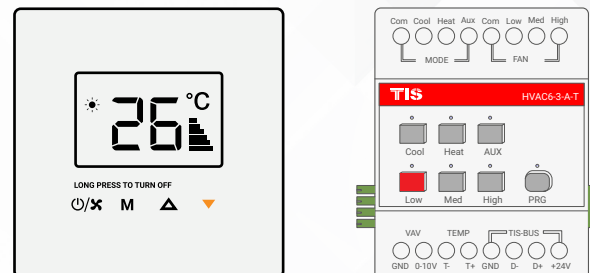





## TROUBLESHOOTING



**The panel's button LED blinks rapidly.**

**Reason:** The panel address conflicts with another device in the TIS network. You need to press and hold any button for 6 seconds so that the panel can get a new address.



**The panel buttons' LEDs do not turn ON, and the device is not powered.**

**Reason 1:** There is no TIS-BUS power or no connection to the L/N input (if used AIR bus-3W converter).

**Reason 2:** The TIS 24V power supply is not connected to the TIS-BUS.



**The wall panels fail to pair with other devices.**

**Reason 1:** The TIS-BUS connection has a problem, or the wire has a short.

**Reason 2:** The manual programming function is disabled on the device (it is enabled by default).



**The wall panels fail to control the device channels.**

**Reason 1:** The TIS-BUS connection has a problem, or the wire has a short.

**Reason 2:** The programming address is faulty.