

INSTALLATION MANUAL

TIS HEALTH SENSOR

Ceiling-mount Healthcare Product









Model: TIS-HEALTH-CM

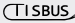

PRODUCT INFORMATION

This product is a ceiling-mount sensor designed to maintain air quality and health measures by regulating temperature, measuring health parameters and detecting dangerous gases.

PRODUCT SPECIFICATIONS

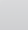
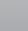
	Input	PIR motion sensor	Dual element pyro-electric ceramic
		Volatile organic compound	Total VOC: 0 ppb -1000 ppb
	TIS BUS	eCO2 sensor	Sense from 400ppm – 5000 ppm
		Temp sensor	Resistance temp. sensor range -40 to 80 C
		Humidity sensor	Sense the range of 0 -99.9%
		Digital input. Open / Close	3 Channels
		Length of connected wire to DI	< 350 meter
		Light intensity sensor	0 – 8000 Lux meter
		Microphone sensor	Sense noise in room
	PIR Detection	Number of devices on 1 line	Max. 64
		Bus voltage	12-32 V DC
	Protection	Current consumption	<15 mA / 24 V DC
	Connection terminal	PIR range	4-6 meters (installation height 2.6 - 3 meters)
		PIR detection angle	110° from the ceiling down
	Operation	Reverse polarity protection	
	Functions	terminal connector 0,25...2mm2	
	Dimensions	Programming button	For assignment of the physical address
		Indicator LED	Blue or Red LED (optional)
		TIS BUS	TIS Protocol messages and commands
		Upgrading	Manual & via software
	Housing	Logic/ Timers	32 Timers and Logic conditions
		Security Function	Away, Night, Day, fire alarm setting
	Barcode	Length × Width × Height	92mm × 39mm × 92mm
	Barcode	Materials	Fireproof ABS & PC
		Casing color	White
		Base color	Black
		IR window cover	Transparent gray
		IP rating	IP 20



BARCODE (UPC-A)





Read Instructions

We recommend that you read this Instruction Manual before installation.



Mounting Location

Install in a dry, indoor area with a suitable temperature and humidity range.



Safety instructions

Electrical equipment should only be installed and fitted by electrically skilled persons.

Failure to follow the instructions may cause damage to the device and other hazards.

These instructions are an integral part of the product and must remain with the end customer.



Data Cable

Use screened stranded RS485 data cable with four twisted pairs. Configure devices in a "Daisy Chain."

Do not cut or terminate live data cables.



Programming

Advanced programming requires knowledge of the TIS Device Search software and instruction in the TIS advanced training courses.



Warranty

There is a two-year warranty provided by law. The hologram warranty seal and product serial number are available on each device.



Simple Installation

You can use 2 screws to install this sensor on the ceiling.





INSTALLATION STEPS

1»

Turn off TIS power supply.



WARNING! HIGH VOLTAGE

2»

Rotate the sensor cover to open it.

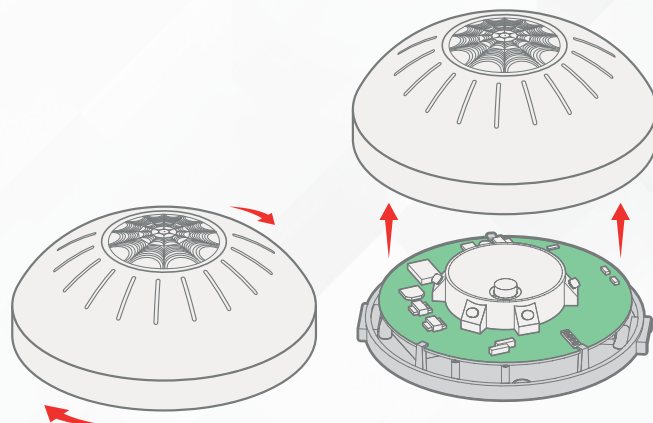

3»

Remove the PCB from the holding pins.

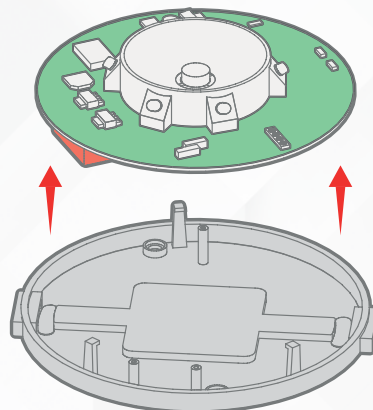

4»

Open the wire holes, and insert the TIS-BUS cable and other 3rd-party digital input (dry contact) cable in the sensor base.

For more information on how different types of 3rd-party sensors connect to this module, please refer to the sensor's connection diagram file.

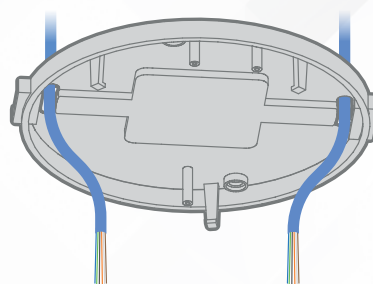



INSTALLATION STEPS

5»

Mount the sensor base on the ceiling with 2 screws.

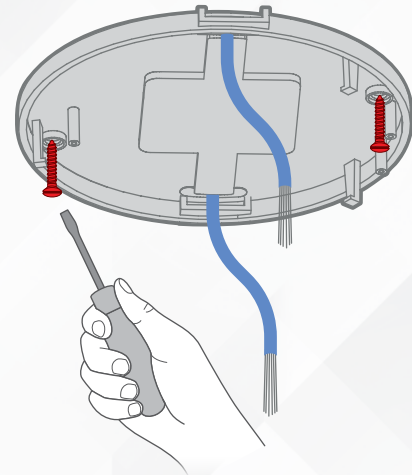

6»

Connect the cables to the 4-pin terminals and Insert the terminals in the board. Make sure to connect the BUS cable to the green connector and the dry contact cable to the red connector.

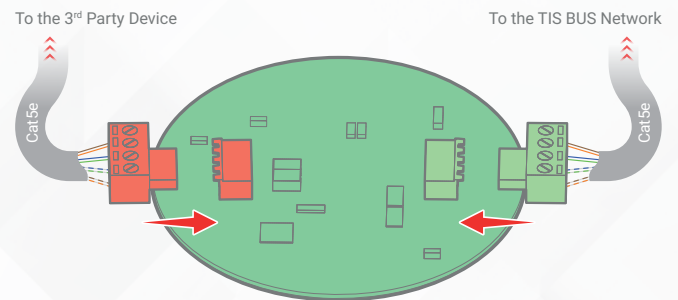

7»

Secure the board inside the sensor base using the base pins.

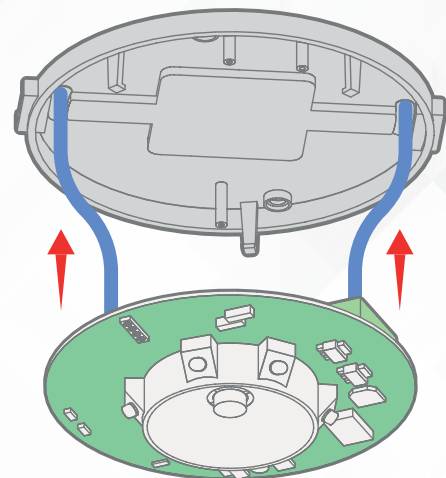



INSTALLATION STEPS

8»

Install the extra 3 screws (optional).

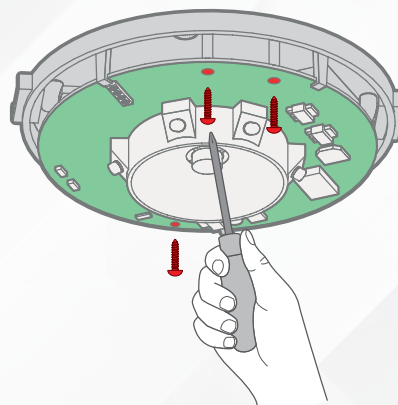

9»

Close the cover of the sensor.

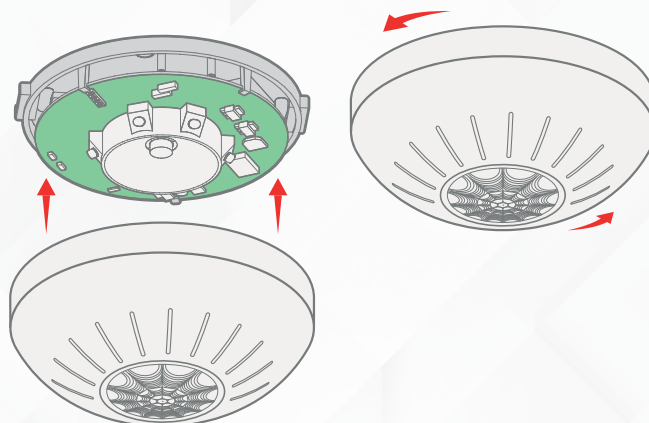

10»

Turn the power supply ON. The sensor LED should turn on.

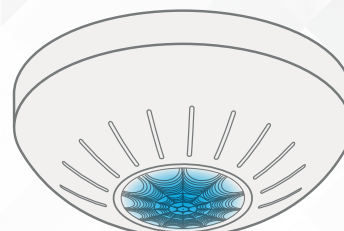



TROUBLESHOOTING



The sensor's LED blinks rapidly.

Reason: The sensor address conflicts with another device in the TIS network. You need to press and hold on the sensor PCB PRG button for 6 seconds so that the sensor can get a new address.



The sensor's LEDs do not turn ON, and the device is not powered.

Reason: The TIS 24V power supply is not connected to the TIS-BUS.



The sensor fails to control the device channels.

Reason 1: The TIS-BUS connection has a problem, or the wire has a short.

Reason 2: The programming address is faulty.



The sensor LED is always off, but it works fine.

Reason: LED is disabled in the software.



The sensor's sensitivity is not strong.

Reason 1: The sensitivity level is reduced in the software.

Reason 2: The ceiling where the sensor is installed is not high enough.