

**TIS-WC-FS80**  
Manual of Intelligent Toilet



# Content

Thank you for purchasing our smart toilet series.

To ensure safety, please read this installation instruction manual carefully and install this product correctly and safely. Our company will not responsible for accidents or injuries that caused by not using the specified parts when installation or not follow the installation instructions. There may be differences between the actual product and the illustrations.

---

Safety Precautions .....	01
Part Identification .....	09
Packing List .....	10
Attention Before Installation.....	11
Installation Method .....	12
Precautions Before Use .....	16
Remote Control Instructions .....	18
Functional List .....	25
Basic operations .....	26
Maintenance Instructions .....	28
Troubleshooting.....	31
Technical Parameter .....	33
Product Environmental Information .....	34
After-Sales Service .....	35

## Safety Precautions

In order to avoid the body damage and property damage , Specifit the distinguish and symbol as follows.

All the information below are concerned about the safty issues, please pay your attention and follow it.

- According to the degree of harm or damage caused by wrong usage, it can be divided into the following levels:



CAUTION

If you ignore this sign and mishandle, you may cause body damage or proeperty damage.

- The following icons are used to illustrate



Prohibition

Refers to the infeasible,  
The content of "Prohibition"



Mandatory

Mandatory Means "must comply"  
with the execution of the content



Prohibition, refers to the infeasible, The content of "Prohibition"



keep away from high temperature and inflammable objects



Prohibited touch by wet hand



Prohibition of watering



Must connect to the earth wire



## WARNING



### Prohibition of watering

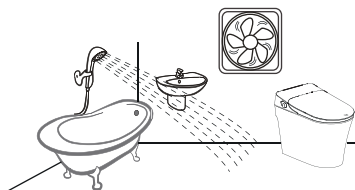

This product is an electric product, so do not place where it is splashed with water or has a high humidity. When using in the bathroom, please install a ventilation fan or a ventilation port. Keep the air circulation in the bathroom.  
--Otherwise, it may lead to a fire or electric shock.



### Prohibition of watering

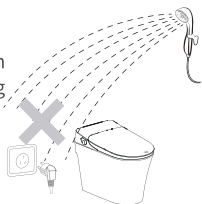

Prohibition of drenching: Do not spray water or detergent on the power plug of the product.  
--Otherwise may result in fire, electric shock, and accidents.



240V~ ☒

50Hz ☒

More than 10A (inclusive) ☒



Please insert the power plug into the outlets with 240V~, 50Hz, 10A above (and on).  
—Failure to do so may result in fire or electric shock.  
—When the power exceeds the socket requirements, it will heat up and cause a fire.



## WARNING

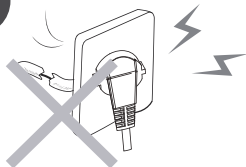

Do not use loose or faulty outlets.

--Failure to do so may result in fire or electric shock.

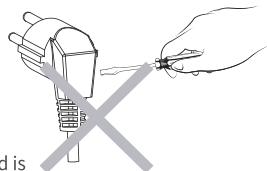

If the power cord is damaged, do not disassemble it yourself.

It must be replaced by the manufacturer's maintenance department or a professional.



Do not touch with wet hands.

Do not use wet hands to insert or remove power plug.

--It may lead to electric shock.

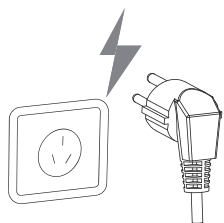

Must connect to the ground wire

Please check if the power outlet is connected to the ground wire or not.

--If the ungrounded product fails or leaks, it may cause electric shock.



## WARNING

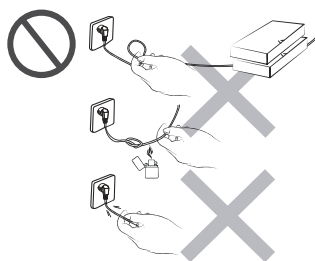

Do not damage the power cord

- Do not damage, do not process, do not heat;
  - Do not bend, do not curl and bind, do not pull;
  - Do not place heavy objects on the power cord.
- Do not continue to using the damage product which may result in fire, electric shock, short circuit and other situation.



High temperature  
flammable materials  
are prohibited

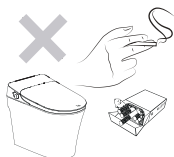

Please do not put the flaming products such as cigarettes close to or into the product.



### Prevention of low temperature burn

If touching the toilet seat prolonged, a certain area of skin may be burned by low temperature heat.

Please keep the seat temperature LOW or OFF when using the toilet seat.

- Children, the elderly, etc. who can not adjust the temperature to an appropriate level by themselves;
- Persons who are unable to move freely, such as the sick or the disabled;
- Heavy drinking and excessive tiredness caused by hypnotic drugs (e.g. sleeping pills, cold medicine) .



## WARNING



It is prohibited to disassemble or modify this product by yourself



Prohibit disassembly: It is absolutely forbidden to disassemble, repair or modify this product by yourself. Failure to do so may result in fire, electric shock and other accidents.



When the following occurs, please remove the power plug and close the inlet valve

- Smoking
- From the pipeline, product leaks from inside out
- The product temperature is abnormally high
- An abnormal sound or smell

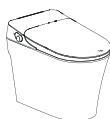

Do not use water other than tap water.  
--Otherwise, skin infection or product failure may occur.



This toilet douche seat must be installed with appropriate backflow protection conforming to the national construction code – volume three.



## ATTENTION

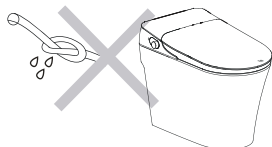

Do not twist or break the inlet pipe. The bending angle of the hose should not exceed 90°. Otherwise, it may cause the water do not inlet or the product leakage.

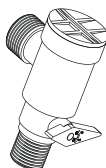

Please tighten well when installing the inlet valve. Otherwise it will cause water leakage.

--When leaking, please close the inlet valve.Prevent damage caused by freezing.

--Freezing will cause water ingress and internal damage, which will cause product leakage.

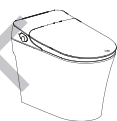

Do not use at temperatures below 0 °C.

-- Please refer to P30 [Long Term Non-Use] , water should be drained from the product to prevent freezing and cracking.



Do not hit the product with violence to prevent leakage.



## ATTENTION

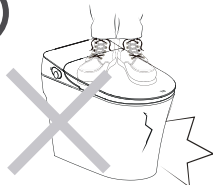

Do not place heavy objects on the seat cover, or stand on the seat cover, and do not hit the product with violence.

--Product fragmentation may cause personal injury.

--Toilet fragmentation may cause problems of water seepage in the room.

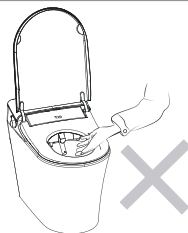

Do not put your fingers or other objects in or block the warm air outlet.

---otherwise it will cause burn, electric shock or burning.



Please use the neutral kitchen cleaner during maintenance.

The following items are prohibited to use: Toilet cleaning agent, household cleaning agent, volatile agents, banana oil etc.

--Otherwise, it may damage the plastic parts, and the shatter from them will cause personal injury.

--Otherwise, the inlet pipe may be damaged, which will result in leaking.



## ATTENTION



For persons with disabilities, physical sensory, mental and general lack of experience (including children).

Please use this product under supervision.

Do not allow children to play with this product. Please do not continue to use when the product is out of order, please contact after-sales service personnel for maintenance.

--Using the product in the event of a malfunction can cause problems such as fire accident, electric shock, or leaking of room. Please contact after-sales service personnel for maintenance.

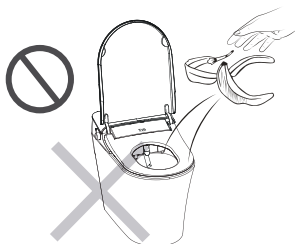

Do not use the toilet bowl to flush anything other than excreta or toilet paper.

--Otherwise, it may lead to toilet block, sewage overflow.



Please do not put newsprint, paper urinals, sanitary napkins and other easy-to-block items into the toilet seat.

## Part Identification

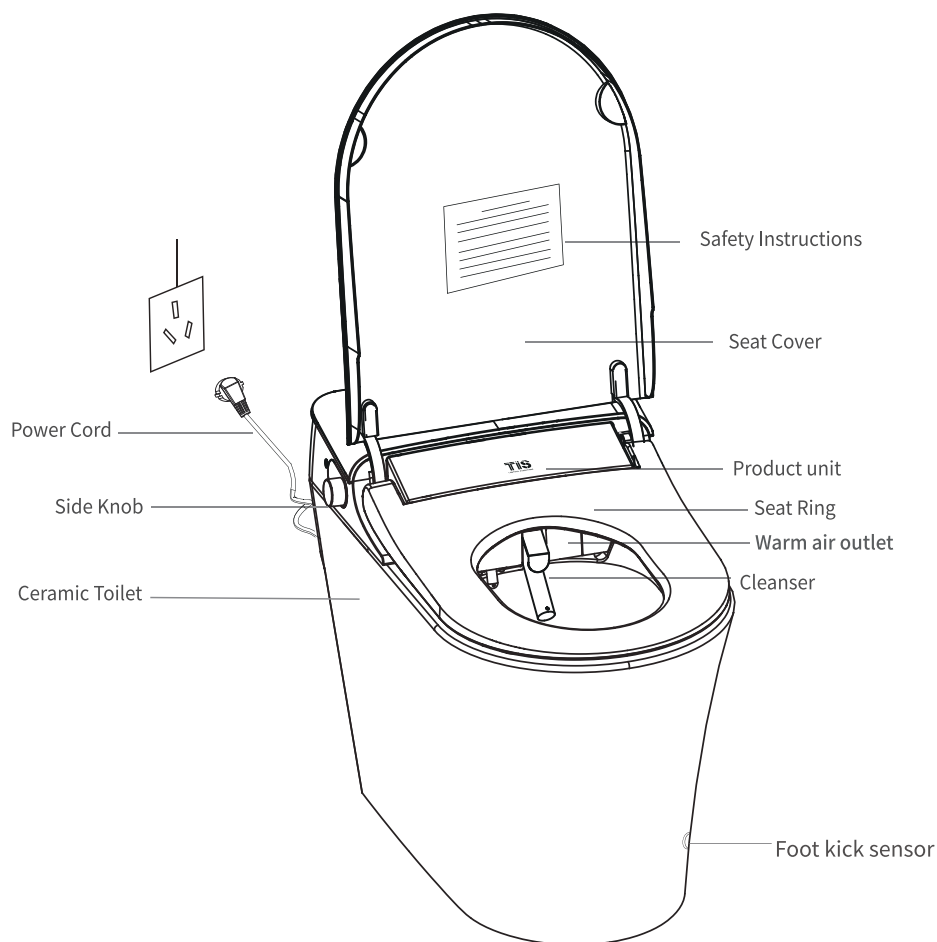

■ The appearance and function are based on the actual object.

## Packing List

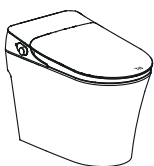

Complete Machine

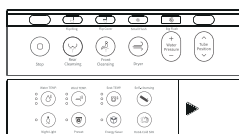

Remote Control Module

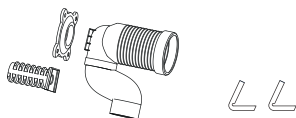

Connector

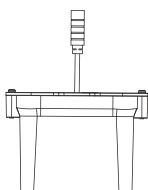

External battery



User manual, Certificate, Warranty Card



Check valve

Filter tennis valve

## Attention Before Installation

### Installation Space

- While ensuring the required installation space, please make sure that the installation of the product does not affect doors open, etc.. The water inlet pipe should be above 150mm off the ground.
- Before installation, please confirm the location of sewage outlet (please refer to the indication shown on the right) .

### Water Pressure

- The lowest necessary water pressure:  $0.07\text{MPa}(0.7\text{ kgf / cm}^2)$ , flow rate  $\geq 4\text{L/Min}$  (flow rate  $> 4\text{L}$  per minute), if the pressure is not reached, the product can not work normally (special measuring tools).
- When used simultaneously with other products such as water taps, the first requirement shall also be met.

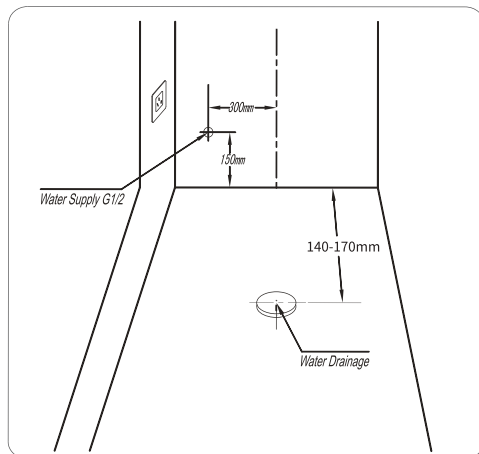

### Installation Drawing

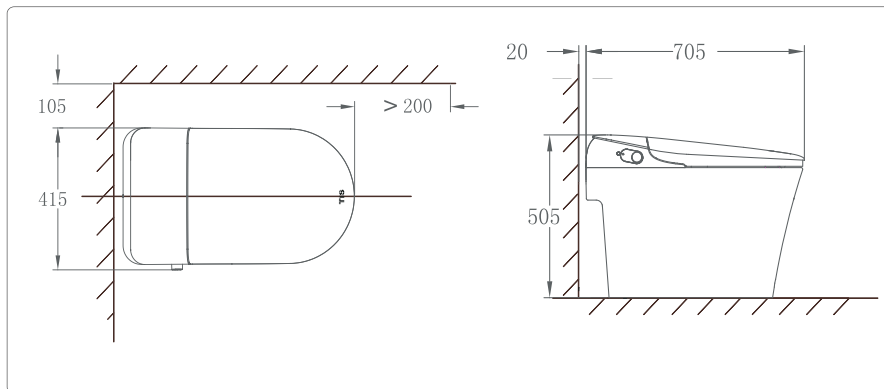

Note: This is the Installation Drawing

## Installation Method

### (1) Installation of Seal Ring and Ceramics

- Firstly, mark a line 325mm from the wall on the floor, then, mark two specific points with the interval of 90 mm, drill a hole on these two points, and fix the support bracket on the floor with screws. (Fig. 1/2).
- Cut the length of the connector and fixing column according to the required distance between the drain holes during installation and after measuring the data. (Fig. 3)
- Insert the connector with the sealing ring into the drain (on the ground), and then fix the fixing column and the base on the wall with screws (drill holes in the wall with expansion screws before fixing). (Fig. 4)
- Placing the ceramic in the installation position, adjust the position of the ceramic so that the ceramic sewage outlet is in a straight line with the connector, and then gently push the ceramic into the installation until it is in place. After the ceramic bowl is installed in place, insert the plastic trim into the two side installation holes of the ceramic bowl, then put two long screws through the plastic trim from the side installation holes to secure the ceramic in place. Finally, cover the decorative piece. (Fig. 5)

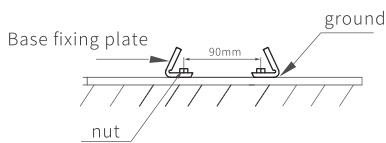

(Fig. 1)

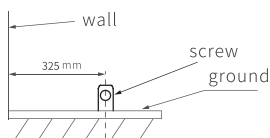

(Fig. 2)

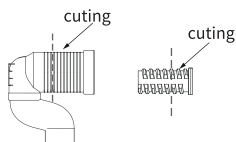

(Fig. 3)

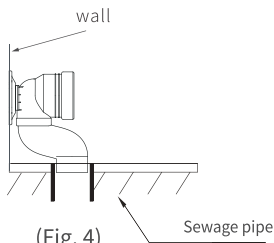

(Fig. 4)

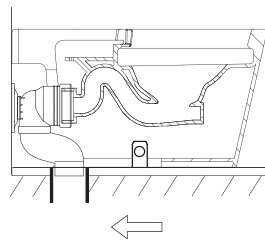

(Fig. 5)

### (2) Connecting Water Supply Pipes

- Turn off the water source.
- After installing the angle valve, open the angle valve switch for more than 1 minute to prevent it from being not used for a long time, and there is dirt inside.
- Connect the components according to the diagram.
- Carefully tighten the installation area and visually check for leaks.

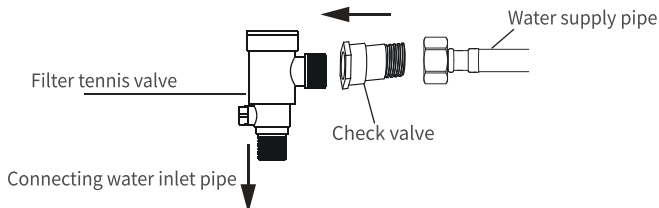

Updated to include a reference that the installation must be in accordance with AS/NZS 3500.2.

## Installation Method

### (3) Smear Silicone Sealant

There is a gap between the bottom of the toilet and the ground, which may stain the ground due to water seepage during cleaning. Therefore, it is recommended to apply silicone sealant around the bottom of the toilet to prevent water seepage.

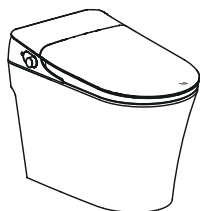

Ceramic toilet

Silicon sealant

### (4) Connect the Power Supply

Open the angle valve and plug in the product. The power cord must be connected to a socket with 240 V~, 50Hz above (including) and safe grounding.

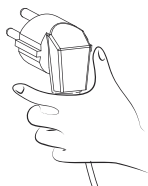

240V~ ☒

50Hz ☒

10A or more (inclusive) ☒

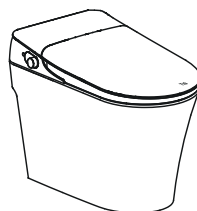

Attention

- Do not spray water on the toilet seat or the dry air outlet.
- If installed in cold weather environment, please keep it in a warm room for 2 hours before installation.
- The company shall not be held liable for any accident or injury caused by failure to comply with the installation instructions or by failure to use specified components at time of installation.

## Installation Method

### (5) Inspection List After Complete Installation

- ★ After the installation is completed, it must be put into trial operation and checked one by one according to the inspection list.

#### Inspection List

- Whether it is connected to the power socket, which can provide the safe grounding of 240V~, 10A,50Hz.
- The plug and socket can not be loosened.
- Make sure the main water inlet valve is open.
- Check whether the joints are tight, fixed, and whether there is leakage (such as cleaning filter, water supply hoses and fixed springs, nuts, etc.) .
- Whether the power indicator lights up.
- Whether the sprinkler system is leaking. Dry the applicator and check for leaks with toilet paper.
- Product functions are normal: buttocks cleaning and bidet (including water pressure adjustment) , warm air drying (including warm air intensity adjustment) , water temperature and seat temperature adjustment, nozzle self-cleaning, automatic deodorant, remote control and the display of the remote control are normal.

★ The above series of actions should be checked.

## Installation Method

### Installation of Main Remote Control

- Choose suitable and dry plane, tear the sponge double-sided
- adhesive, and fix the remote control bracket. Insert the remote control into the bracket. (It is recommended to fix the remote control in a ventilated and easy-to-use position. If you do not use it for a long time, please remove the battery from the remote control. (see right picture)

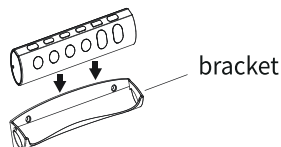

### Precautions Before Use

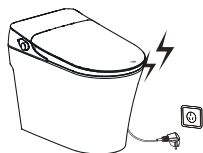

When it thunders, please disconnect the power plug from the socket.  
-- Or there may be a malfunction.



Prohibit

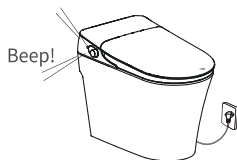

After completed installation, plug in the outlet, power on and the machine shall run a self-test. After completed the self-test, a "Beep" sound should emitted which indicates that the whole machine has been electrified

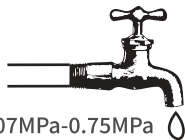

0.07MPa-0.75MPa

Tap Water pressure must be at the range of 0.07MPa-0.75MPa when using this product.

## Precautions Before Use

- During daily use, please avoid spraying water onto the body of the machine to prevent damage from internal water.
- After the remote control has been used for a long time, the exhaustion of the battery may affect the signal reception. In this case, the battery should be replaced.
- During the process of turning over the seat cover and the seat ring, foreign objects should be prevented from being stuck on the moving track of the cover and the ring.  
-- Failure to do so may cause a malfunction.



Prohibit

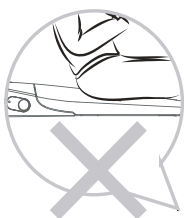

Do not sit on the seat cover when it is closed, or do not lean against the cover when it is open.  
- Doing so may scratch the seat cover and cause malfunction.

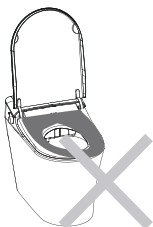

Please do not use cloth covers or mats on the seat.  
- Failure to do so will result in poor seat induction.

## Precautions Before Use

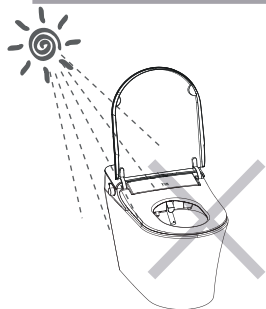

Please keep out of direct sunlight.  
--Otherwise, it will lead to discoloration of the product  
and it will not work properly.



Prohibit

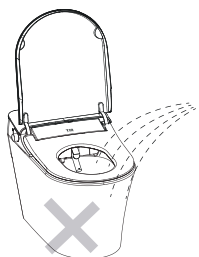

Do not spray urine on the product or the nozzle, otherwise it  
may cause malfunction.



Please do not force the cover and seat ring closed.  
- otherwise the product may be damaged.



In the daily use of the remote control should avoid contact with  
the water source, in order to prevent internal water damage.

## Remote Control Instructions

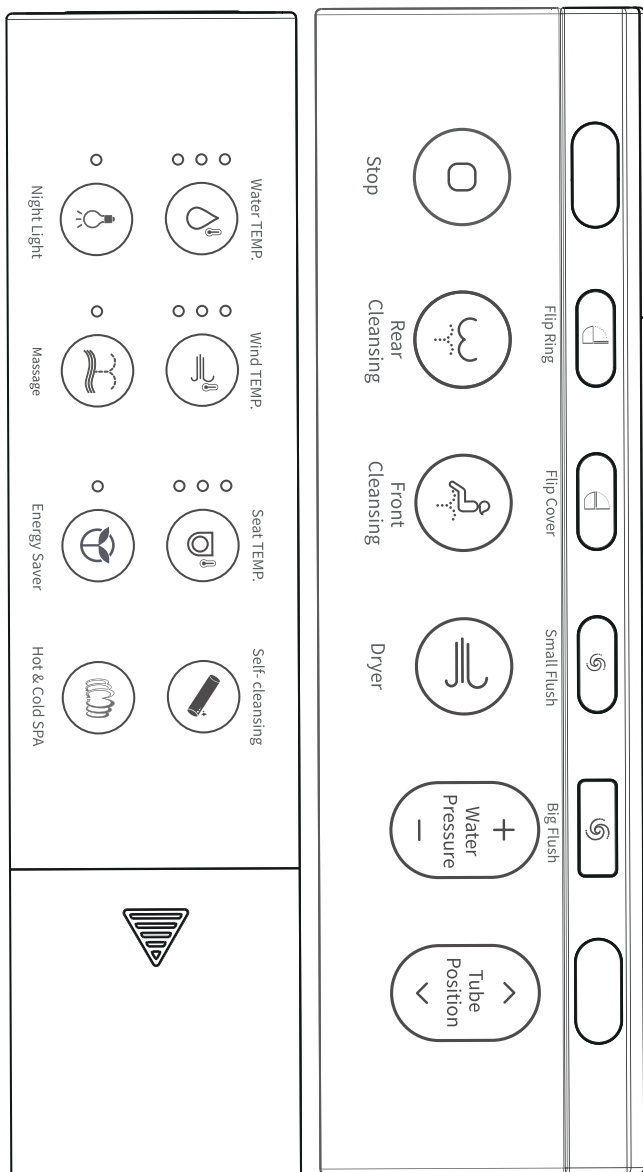

## Remote Control Instructions

### Stop

Stop functions that are running on the device. When the seat is not occupied, long press the stop button for more than 5 seconds to enter the standby mode and all functions will be turned off. Press the stop button again to exit the standby mode and all functions will be restored.

### Rear Cleansing

In the seated state, the button starts to perform the 'Rear Cleansing' function; The cleaning time of this function is 4 minutes; To stop, press the 'Stop' button. Press the 'Water TEMP.' button to adjust the water temperature; Press the '+/-' key to adjust the water washing pressure; Press '^v' key can adjust the position of the cleaning tube; Press 'Massage' button to turn on/off massage cleaning. When the Rear Cleansing function is turned on, press this button again to turn on the Rear Cleansing reciprocating function.

### Front Cleansing

In the seated state, the button starts to perform the 'Front cleaning' function; The cleaning time of this function is 4 minutes; To stop, press the 'Stop' button. Press the 'Water TEMP.' button to adjust the water temperature; Press the '+/-' key to adjust the water washing pressure; Press '^v' key can adjust the position of the cleaning tube; Press the 'Massage' button to turn on/off the massage cleaning; When the front cleaning function is enabled, press this key again to enable the front cleaning reciprocating function.

## Remote Control Instructions

### Dryer

In the seated state, the button starts to 'Dryer' function; Drying function is 4 minutes; To stop, press the 'Stop' button. Press the 'Wind TEMP.' button to adjust the air temperature. The air temperature adjustment range is 0-3 (0 stop is no heating at normal temperature), the air temperature indicator shows the current gear, and when the indicator bar is all off, it is 0 stop no heating. When the drying function is started, the deodorization function automatically stops; After the drying function is turned off, the deodorization function resumes and starts. Note: Long press the 'Dryer' button for more than 5 seconds to turn on/off the deodorization function.

### Water Pressure

In the cleaning mode, it is used to adjust the water pressure. The water pressure adjustment range is 3. Press the '+' key to increase the water pressure by one step, and press the '-' key to decrease the water pressure by one step.

### Tube Position

It is used to adjust the tube position in the cleaning mode, and the tube position can be adjusted in 3 levels. Press '^' Key tube position extend one gear, press 'v' The cleaning position is shortened by one gear.

### Flip Ring

When not in the seat, press the 'Flip Ring' key, you can automatically open and close the seat ring. Note: When the seat cover is closed, press this key to automatically open the seat cover and then the seat ring; When the seat cover and seat ring are open, press this key to automatically close the seat ring.

## Remote Control Instructions

### Flip Cover

When not in the seat, press the remote control top 'Flip Cover' key, you can automatically open and close the seat cover. Note: When the seat cover and seat ring are open, press this key to automatically close the seat ring first, and then automatically close the seat cover. When the seat cover is closed, press this key to automatically close the seat cover.

### Small Flush

Please press this key, the product will be a small flush, this function does not support continuous operation, need to wait 1 minute before the next round of flushing.

### Big Flush

Please press this key, the product will be a big flush, this function does not support continuous operation, need to wait 1 minute before the next round of flushing.

## Remote Control Instructions

### Water TEMP.

Used for water temperature regulation during cleaning mode. The adjustment range is 0-3 (0 stop is normal temperature without heating), and the cleaning indicator shows the current gear.

### Wind TEMP.

Used for air temperature adjustment in warm air drying mode. The adjustment range is 0-3 (0 gear at normal temperature), the wind TEMP. indicator will show the current gear, and when the indicator is all out, it will be 0 gear without heating.

### Seat TEMP.

Press this key to adjust the seat temperature. The temperature adjustment range of the seat is 0-3 (0 gear is normal temperature without heating). The seat TEMP. indicator will show the current gear.

### Automatic flushing

1. Leave the seat directly after cleaning, and flush automatically after 10 seconds;
2. Within 5 seconds, the human body shall leave the seat without ceramic flushing;
3. After sitting for more than 5 seconds, the human body should leave the seat and carry out a ceramic flushing;
4. Long press the 'Big Flush' key for more than 5 seconds to turn on/off the smart punch mode.

## Remote Control Instructions

### Self- cleansing

When not seated, press this key to turn on the nozzle self-cleaning function. After opening, the cleaning tube will extend out. At this time, the cleaning tube can be cleaned with a soft wet towel or a soft brush. The cleaning tube will automatically retract after 2 minutes.

### Night Light

Press this button to turn on/off the night light. The soft light will shine on the ceramic. After 10 minutes, it will automatically turn on or off according to the brightness of the room.

### Massage

In the cleaning mode, press this key to enable the massage function. After the function is enabled, the cleaning water pressure changes automatically to achieve the massage effect. This function can only be used when the rear wash or front wash function is turned on.

### Energy Saver

Press this key to enable/disable the energy saving mode. After the energy saving mode is enabled, the machine is in the energy saving state, the icon of 'energy saving' on the display screen is lit up, and the blue light on the knob is lit up. In the energy saving mode, the seat ring temperature will automatically adjust to the power saving mode according to the ambient temperature. The energy saving mode will be removed after the seat is installed and automatically restored to the energy saving mode 10 minutes after leaving the seat.

## Remote Control Instructions

### Hot&Cold SPA

After sitting down, press the 'Hot & Cold SPA' button to open the hot and cold SPA function: alternately spray warm water and room temperature water from the rear cleaning mouth to achieve the effect of hot and cold massage. The cleaning time of this function is 4 minutes: if you want to stop halfway, please press the 'Stop' key: After the hot and cold SPA function is completed, the 'Hot & Cold SPA' key again to turn on/off the reciprocating mode: press the '+/-' water washing pressure adjustment key: press '△▽' Key Adjust the cleaning tube position.

Note: When the water temperature is at 0, this function cannot achieve alternating hot and cold changes.

### Bubble cleansing

long press '△' More than 5 seconds can be opened and closed bubble cleaning, bubble cleaning after opening, through the air pump pressurization, water pressure is greater, cleaning strength is stronger.

### Ring cover induction

When the human body is close to the foot feeling area and the seat cover is closed, the machine will automatically open the seat cover;

Close to the second time, automatically open the seat ring;

Near the third time, automatically close the seat ring and seat cover, and then carry out a flushing;

Functions cycle in the above order;

In the seated state, the function fails;



## Functions List

Seat temp	<input type="radio"/>	Air Purification	<input type="radio"/>
Hot and cold SPA	<input type="radio"/>	Microwave module	<input type="radio"/>
Seating induction	<input type="radio"/>	Digital display panel	<input type="radio"/>
Massage	<input type="radio"/>	Flip seat/cover	<input type="radio"/>
Flush	<input type="radio"/>	Ring cover induction	<input type="radio"/>
Night-light	<input type="radio"/>	Self-Cleaning nozzle	<input type="radio"/>
Bidet	<input type="radio"/>	Power failure flushing	<input type="radio"/>
General	<input type="radio"/>	Flush away from the seat	<input type="radio"/>
Close the cover and flush	<input type="radio"/>	Position cleaning	<input type="radio"/>
Reciprocating	<input type="radio"/>	Instantaneous heating	<input type="radio"/>
Warm Air	<input type="radio"/>	Energy Saver	<input type="radio"/>
Deodorization	<input type="radio"/>	Prewet	<input type="radio"/>
		Water Purification	<input type="radio"/>

Attention: "O" means to configure this function, "—" means no such function.  
The function is subject to the physical machine

## Basic Operations

### Knob Switch Description

A knob switch is on the side of the product body. If the remote controller is damaged or the battery is exhausted, the cleaning and drying functions can be turned on by the knob switch.



**Flush function:** When not seated, gently press the knob stop button in the middle to carry out a flush. Long press the knob stop button in the middle of the seat for more than 3S for a flushing + drying;  
**Stop function:** Long press the knob stop button in the middle for more than 3S when the seat is not seated. In the seat state, gently press the knob stop button in the middle to stop the current function.



**Front washing:** turn clockwise once when sitting, turn on the front washing function, turn clockwise once again when cleaning, turn on the front washing reciprocating cleaning mode.  
**One-button full automatic :** turn clockwise for more than 3 seconds when sitting, turn on one-button full automatic ;  
When cleaning, turn clockwise for more than 3 seconds to open the one-click automatic reciprocating cleaning mode.  
**Note:** One-click automatic : When the front cleaning function ends or manually stops, the drying function + flushing is automatically entered.



**Rear cleaning:** Rotate counterclockwise once while sitting, turn on one-button rear cleaning. Rotate counterclockwise once again while cleaning, turn on Rear cleaning reciprocating cleaning mode.  
**One-button full automatic :** Rotate counterclockwise for more than 3 seconds while sitting, and turn on one-button full automatic ;  
When cleaning, turn counterclockwise for more than 3 seconds, and open the one-button automatic reciprocating cleaning mode.  
**Note :- Key Automatic:** When the rear cleaning function ends or manual stop, it automatically enters the drying function + flush.

**Note:** When the one-button front cleansing-only, one-button rear cleaning, one-button fully automatic (rear cleansing), one-button fully automatic (front cleansing) function is turned on, the water pressure, tube position, water temperature, and wind temperature are set at the last time.

## Description of Microwave Induction

When the automatic flap function is turned on, the intelligent toilet can detect the approach of the human body, automatically open the seat cover, and automatically close after 2 minutes when it is not used.

## Display Description



This icon indicates the water temperature, and the value displayed on the right is the current set temperature.



This icon indicates the seat temperature, and the value displayed on the right is the current set temperature.



This icon indicates that the machine is in energy saving mode.

27

°C

When not seated, the value is the current indoor temperature; The value after landing is the seat ring temperature set for the current gear; In the cleaning state, the value is the water temperature set in the current gear.

Note: the temperature displayed on the screen is the temperature set in the current gear (except room temperature), not the real-time temperature when the current function is operating.

F0

When setting the gear of temperature, seat temp, warm air and foam quantity on the remote controller, the display screen will automatically display the corresponding gear (such as F0/F1/F2/F3), and automatically switch back to the temperature display after 5 seconds.

## Power Outage Flushing

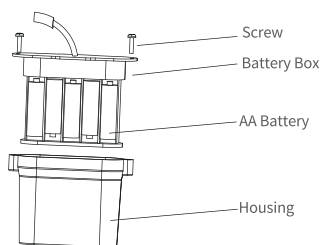

1. Use a Phillips screwdriver to remove the two screws here;
  2. Remove the battery box and place 10 cells AA batteries (pay attention to the positive and negative of the battery);
  3. Replace the battery box and tighten the screws;
  4. Connect the component of the battery box with the connection wire of entire machine battery box (the battery box connection wire is located in the shown place);
  5. After a power outage, press the knob lightly to perform ceramic flushing.
- Note: Customers are advised to purchase AA batteries by themselves.

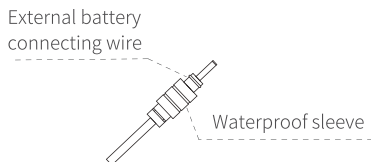
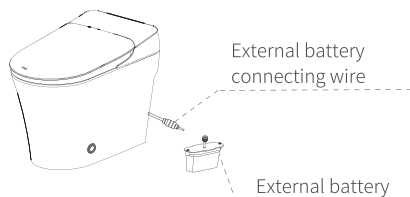

Note: When battery powered, the remote control cannot control the machine. The flushing function needs to be activated by pressing the flushing key on the knob.

## Maintenance Instructions

### Daily Maintenance Method

Please remove the removable accessories before maintenance, so that the maintenance is more convenient.

■ Before maintenance:

■ Make sure the power is off.

■ Do not allow water to enter the product during maintenance.

Be sure to wipe the detergent after cleaning, to avoid its residue in the body of the product and the gap between the toilet.

### Product Surface Maintenance

■ Please wring out the soaked soft cloth before use.

⊗ Do not rinse with water (causing malfunction).

⊗ Do not wipe with a dry cloth or paper towel (causing scratches).



■ If the product surface is dirty, use a neutral detergent for the bathroom. After dilution, apply a small amount on the soft cloth to wipe the product, and then immediately remove the residual detergent on the surface with a clean damp cloth.

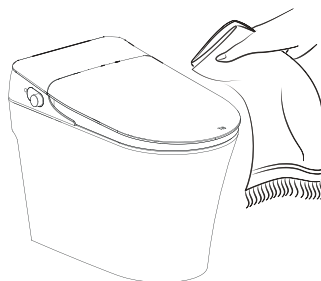
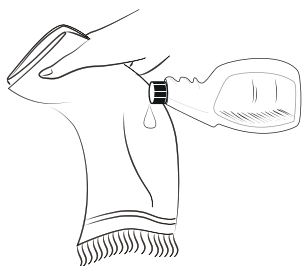

## Maintenance Instructions

### Nozzle Maintenance

- When the toilet is not seated, press the [**Self-cleansing**] to turn on the nozzle self-cleaning function.
- When the machine is on, the cleaning nozzle tube will extend, at this moment, the tube can be cleaned with a soft wet towel or a soft brush. It will automatically end after 2 minutes. Press this button to continue again.
- It is forbidden to pull out or push in the nozzle so as not to damage the product and cause failure.



## Maintenance Instructions

When not used for a long time

1

--- Close the inlet valve to stop the water inlet

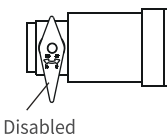

2

--- Use a wet towel to make the seat ring sense, then press the general hip cleaner button on the remote control or the operation panel several times, as so to run out of water inside the machine.

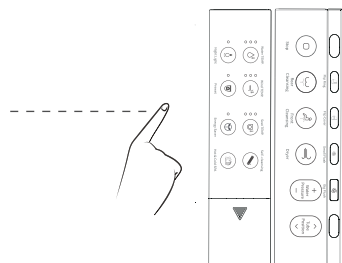

3

--- Disconnect the power supply

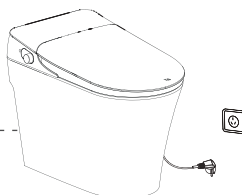

4

--- Remove the battery from the remote control.



### Attention

- ⚠ It is strictly forbidden to spray water onto the toilet bowl or to the dry air outlet.
- ⚠ If it is installed in a cold weather, keep it in a warm room for 2 hours before installation.

## Troubleshooting

Phenomenon	Confirmation	Treatment
Fail to work	Whether the seat ring sensing area is covered with cloth, mat and other items.	Please remove the cloth cover, mat, etc.
	Whether there is a power cut	Please wait for power restoration
	Is the socket loose or poorly connected	Please plug in the plug to ensure good power supply
	If the power button is pressed	Please press the power button of the toilet
Washed without water	Is the water shut off	Please wait for the water supply to be restored
	Whether the inlet angle valve is open	Open the inlet angle valve
	Is the filter clogged with dirt	Please clean the filter
	Whether the water supply hose is bent or blocked	Exclude water supply hose bending
Insufficient washing water	Is the water pressure set too low	Adjust water pressure
	Is the filter clogged with dirt	Please clean the filter
	Is there a blockage in the nozzle	Please clean the nozzle
Water temperature is not hot enough	Is the water temperature set too low or in normal temperature	Please follow P19.P20.P21.P22.P23.P24 pages to reset the water temperature.
Water stop during washing	<ul style="list-style-type: none"> <li>Pressing the [General] hip cleaning button or the [Bidet] button, it will automatically stop in about 60 seconds.</li> <li>Leave the seat in the midway</li> </ul>	Please press the [General] hip wash button or the [Bidet] button again.

## Troubleshooting

Phenomenon	Confirmation	Treatment
Insulation seat ring is not hot	Whether the thermal insulation temperature is set to low or off.	Please follow P19.P20.P21.P22.P23.P24 pages to reset the seat temperature.
	Whether it is set in the energy saving state?	Please press the the energy saving button on operation key to be out of the energy saving mode.
	Whether there is a power outage?	please wait for power supply recovery.
Warm air temperature is low	Whether the warm air drying temperature is set too low or off?	Please follow P19.P20.P21.P22.P23.P24 pages to reset the warm air drying temperature.
Warm wind stopped midway	<ul style="list-style-type: none"> <li>● Press the warm air drying button to stop automatically after about 4 minutes.</li> <li>● Leave the seat in the midway</li> </ul>	Please press the Warm Air drying button again

## Technical Parameter

Name	TIS-WC-FS80 Intelligent Toilet
Rated power	1080W ①
Maximum power	1500W ②
Rated voltage	240V~
Water inlet temperature	1-35℃
Ambient temperature	0-40℃
Water supply method	Waterway direct connection
Water pressure operating range	0.07Mpa- 0.75Mpa 0.07MPa (dynamic)
Safety device	Leakage protection device, water overpressure protection device

## Technical Parameter

Name		TIS-WC-FS80 Intelligent Toilet
Cleaning device	Heating method	Instant
	Warm water temperature	four gear (normal temperature - about40°C)
	Ejection amount	General About0.3 - 0.75L/min
		Bidet About0.3 - 0.75L/min
		Self-cleaning About0.3 - 0.75L/min
	Spray method	General Bubble soft spray
		Bidet Bubble soft spray
	Safety device	Temperature controller, temperature fuse, temperature sensitive switch
Deodorizing device	Deodorant	Acticarbon + Catalyst deodorant
	Air volume	0.2m <sup>3</sup> /min
Drying device	Wind temperature	Four grades air temperature ③ (normal temperature55°C)
	Safety device	Temperature controller, temperature fuse
Insulated seat ring	Surface temperature	4 grades (Normal temperature-approx. 40°C)
	Safety device	Temperature controller, temperature fuse
	Soft closing	Damping cushioning device of seat and cover
	Power	45W

Executive standard:GB 4706.1, GB 4706.53, GB 38448

Note: ① Test conditions: the air pump is closed, the ambient temperature is 20 °C, the water entry temperature is 14-16°C, the water entry dynamic pressure is 0.2MPa, the seat temperature (high grade 3) the water temperature (high grade 3), the front cleaning water pressure (high grade 3), and the integrated power measured at the end of the clean water from the front cleaning mouth to the beginning.

② Test conditions: air pump off, water inlet temperature 5°C, water inlet dynamic pressure 0.2MPa, seat temperature (high grade 3) and in heating mode, water temperature (high grade 3), front cleaning water pressure (high grade 3), flushing measured maximum power.

③ The above ①② test conditions do not enter the water pressure massage mode, and in the case of air pump closed (long press the ‘ ^ ’ Air pump can be turned on/off for more than 5 seconds).

## Product Environmental Information

Parts						
	Pb	Hg	Cd	Cr(VI)	PBB	PBDE
Circuit board	X	O	O	O	O	O
Plastic parts	O	O	O	O	X	X
electric machinery	X	O	O	X	O	O
other parts	X	O	O	O	O	O



This table is drawn up according to the provisions of SJ/T11364

O: indicates that the hazardous substance in all homogeneous materials of the component is below the required limit according to GB/T 26572.

X: indicates that the hazardous substance is at least one of the homogeneous materials, which exceeds the required limit according to GB/T 26572.



This sign indicate that the product has an environmental protection period of 10 years under normal use.

Repair Service Card			
Product number			
Serial number		Date of purchase	
Telephone			
State	City	Dealer name	
<p>Maintenance regulations:</p> <ol style="list-style-type: none"> <li>Follow the instructions and precautions for use. If there is a malfunction after normal use, free maintenance will be carried out during the warranty period.</li> <li>Please contact customer service center. Please show your maintenance card during repair.</li> <li>During the warranty period, the following cases are charged for repair. <ul style="list-style-type: none"> <li>- Failures due to inadvertent or outdated use and failures due to improper repair or modification.</li> <li>- Failure or damage to the mobile installation location.</li> <li>- Failure or damage due to fire, earthquake, flood, lightning and other natural disasters, pollution or abnormal voltage.</li> <li>- Failure or damage due to the use of non-established power sources (voltage, frequency).</li> <li>- For use other than in general household, malfunction or damage.</li> <li>- This service card cannot be provided.</li> <li>- When the customer name, purchase place, installation date light content, or unauthorized modification of content is not filled in this service card.</li> </ul> </li> <li>This repair card is no longer issued. Please keep it safe.</li> </ol> <p>About the service:</p> <p>Customer rights The customer has the right to repair free of charge in the event of a failure within one year from the date of purchase. However, due to customer's fault or natural disaster, even if it is under warranty, it will be charged for repair.</p>			

First union: preserved by customer





Product Name:

**Smart Toilet**

Product category:

**See Box Label**

Machine water consumption:

**See Box Label**



Inspector :



Date of Produce :